

DESCRIPTION	PAGE(S)
Astragals	
Flat89
"h" Type125
Z Type90
Bevels26-27
Bi-Fold Doors124
Bottom (Semi-mortise)95
Caps (Flush)31-32
Clearances24-25
Construction Type (Series)	
6071-2
7073
7274
7375
7476
7577
84710-14
85715-19
CURRiStain Door125
CURRiStain Six Panel Door131-132
Dutch Doors40
Dutch Door Shelves41-42
Edge Seams28
End Channels29
Face Types 1 & 2 (old style)44-47, 60-65, 71-72
Face Types 9 & 10 (standard kit)139-160
FEMA 320 Door Construction137-138
Food Pass (Reinforcement)123
Glass Sizes (Visible)48-59
Glass Moulding	
Type 1 (old style)66-67, 73-75
Type 2 (old style wide pocket)75-76
Type 3 (Custom)73, 77, 79
Type 4 (Custom)78-79
Type 7 & 8 (Custom)127
Hardware	
ElectroLynx System129
Locations35-39
Reinforcement - Preparation	
Closer/Holder91-92
Concealed Closer93-94
Flush Bolts120-121
Hinge	
Hinge Preparation, 10" Blank34
Standard Mortise2
Surface Mounted20
Overmortise-double Mortise9
Locks	
Cylindrical96-102
Cylindrical Lock - Deadlock115
Deadlocks116-117
Pocket118

TYPES 1 & 2

SEE PAGE 155 FOR CURRIES STANDARD WINDOW KIT INFORMATION.

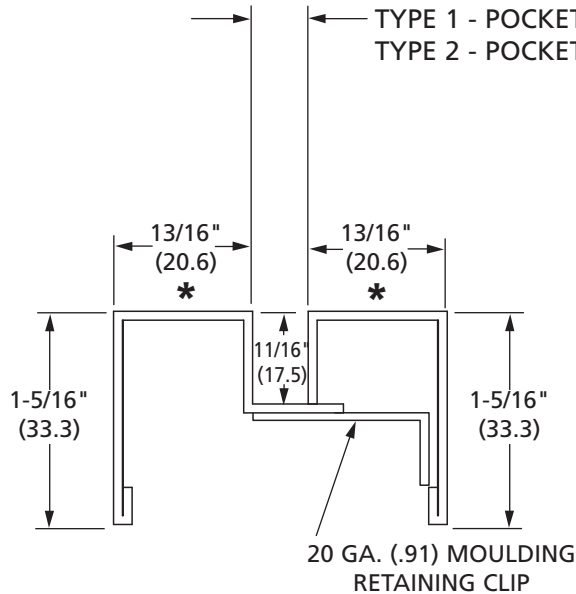

* VARIES WITH POCKET

NOTE: PLEASE NOTE WHEN KITS SHOULD BE USED ON 14 GAUGE DOORS.

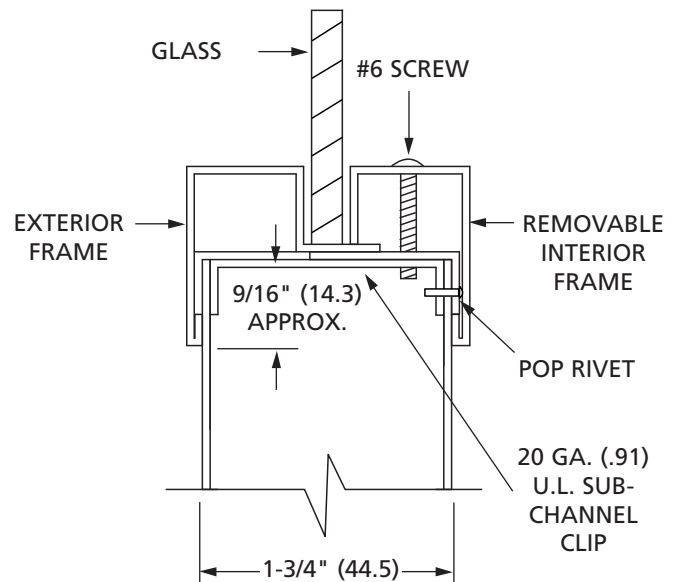

18 GA. (1.2) GALVANIZED STEEL VISION LITE FRAME

STEEL VISION LITE FRAME KITS AND STICK LENGTH PARTS ARE AVAILABLE FOR USE ON 847 SERIES DOORS.

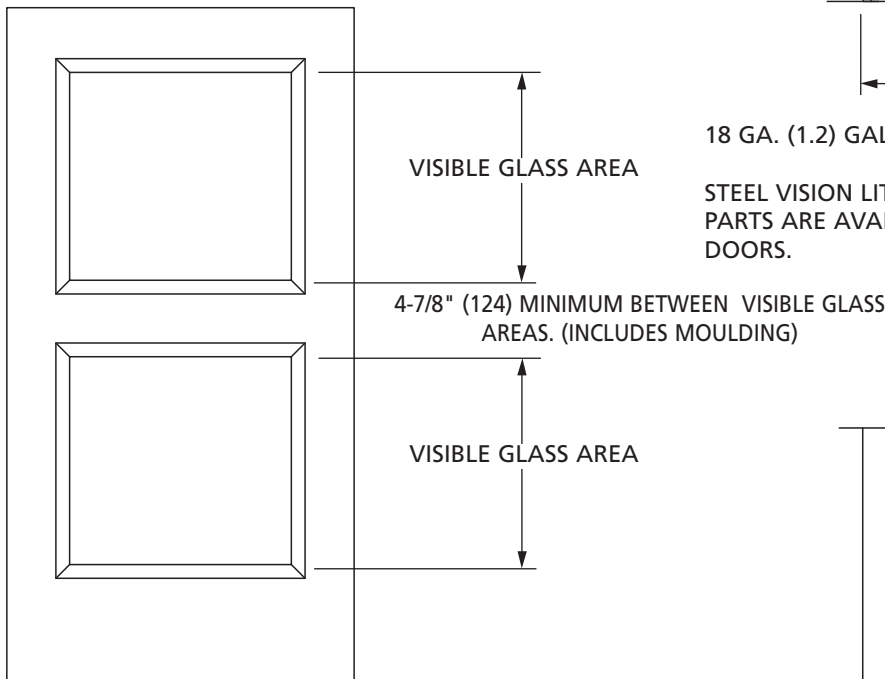

NOTE: ON FIRE LABEL DOORS USE A 6" (152.4) MINIMUM STILE BETWEEN VISIBLE GLASS AREAS AND BETWEEN VISIBLE GLASS AND EDGES OF DOOR.

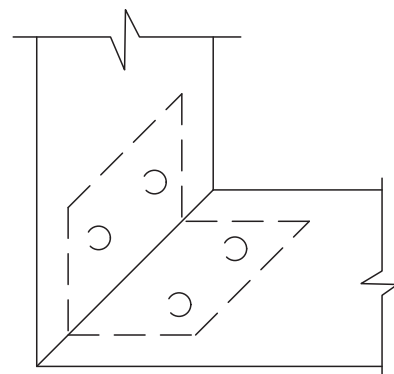

CORNER DETAIL WITH CORNER CLIP WELDED IN

76 Wide Pocket Glass Moulding DOOR TECHNICAL DATA



February, 2009

ASSA ABLOY, the global leader
in door opening solutions

TYPE 2 (old style kits)

SEE PAGE 155 FOR CURRIES STANDARD WINDOW KIT INFORMATION.



1-1/8" POCKET

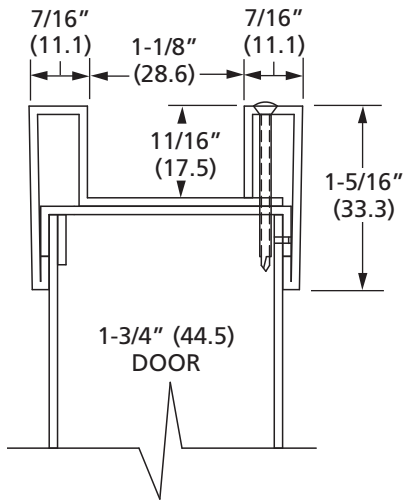

7/8" POCKET

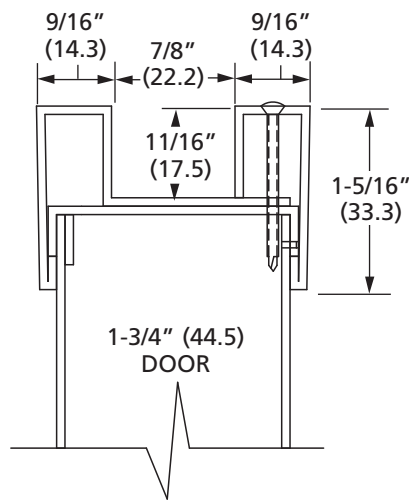

5/8" POCKET

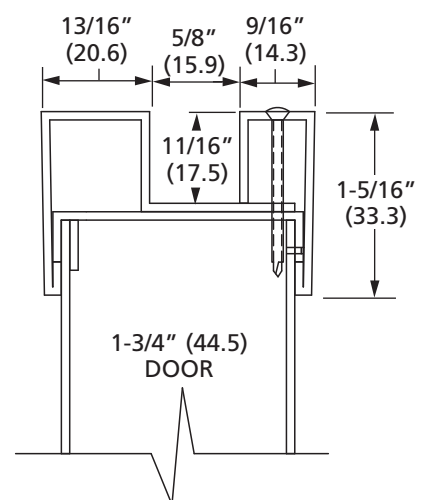

Rabbeted Door and Panel



NOT U.L. APPROVED

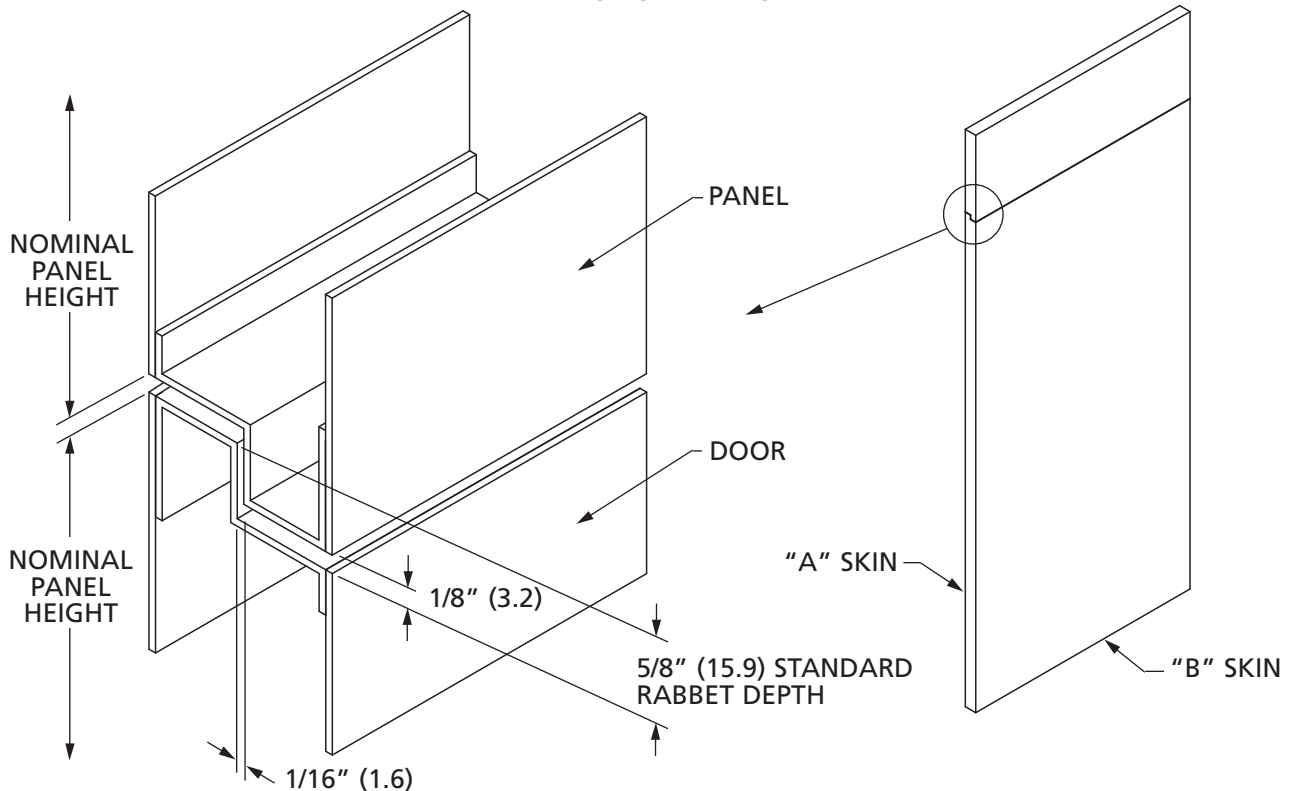

1-3/4" (44.5) ONLY

Type 9 & 10 Window Moulding



STANDARD LOCATIONS FOR DOORS 7'2" (2184.4) AND UNDER

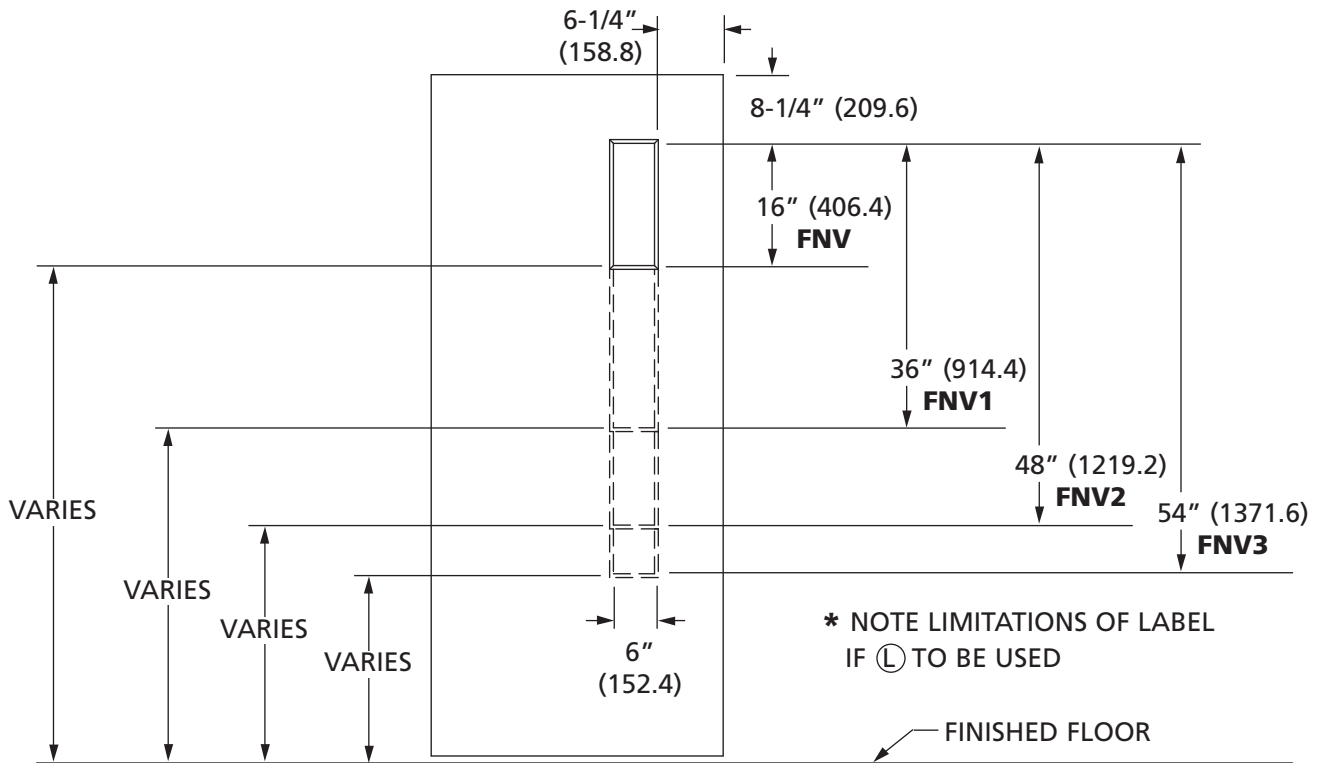

STANDARD LOCATIONS FOR DOORS OVER 7'2" (2184.4)

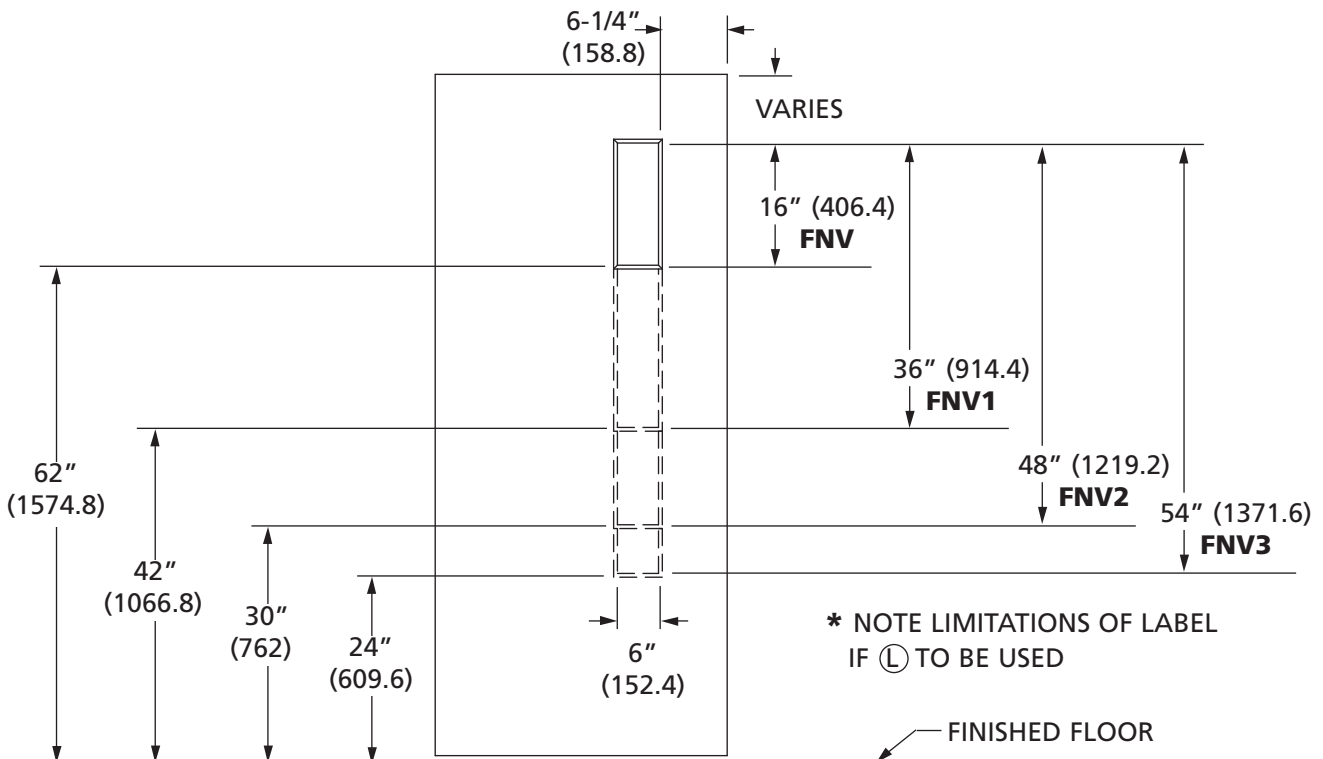

DOOR TECHNICAL DATA

February, 2009

Type 9 & 10 Window Moulding

ASSA ABLOY, the global leader in door opening solutions

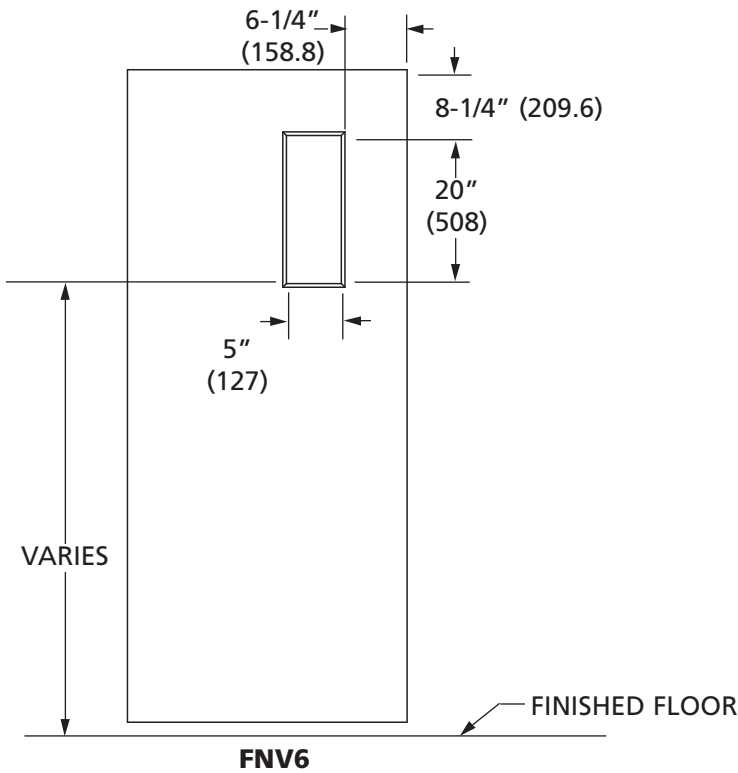
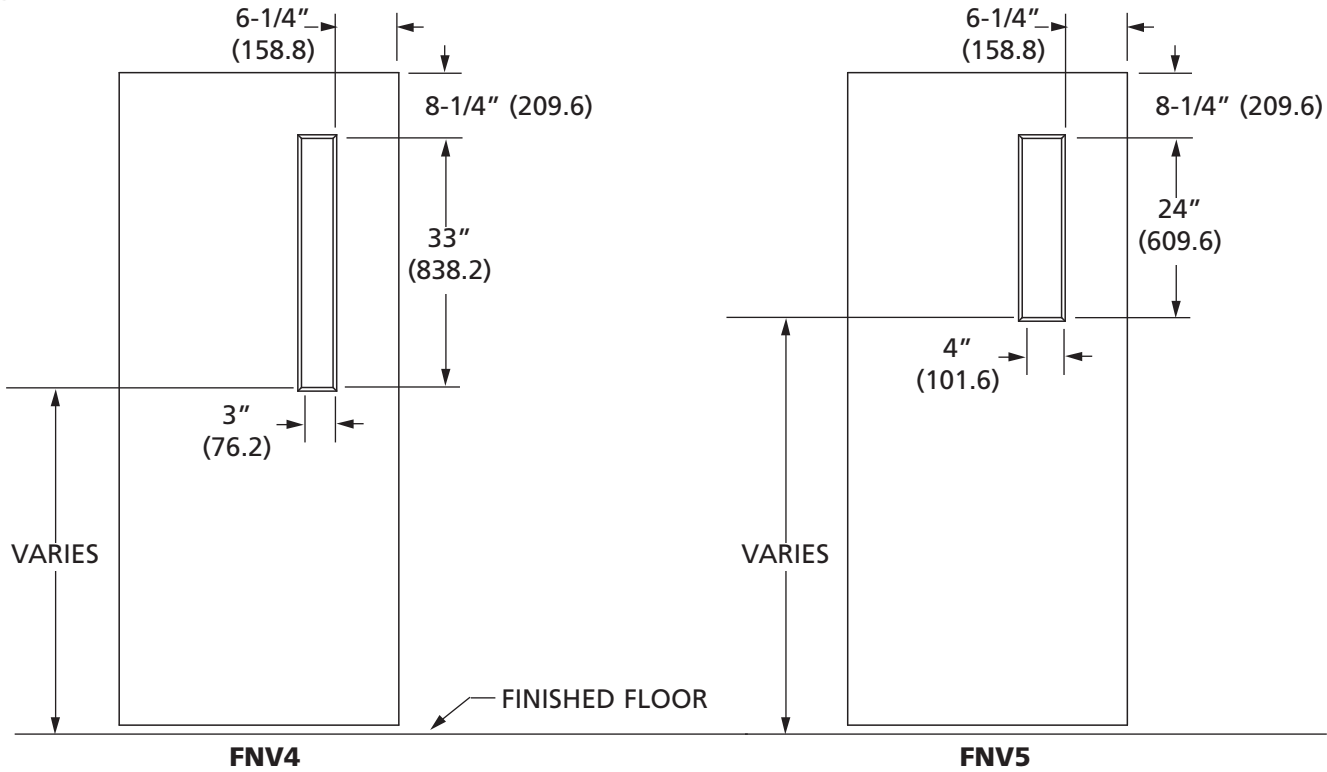

STANDARD LOCATIONS FOR DOORS 7'2" (2184.4) AND UNDER

Type 9 & 10 Window Moulding

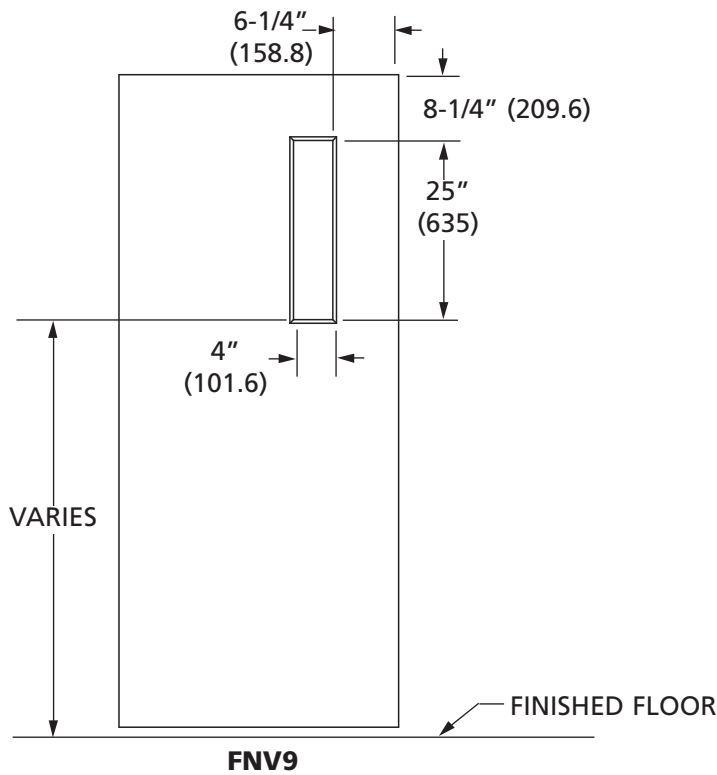
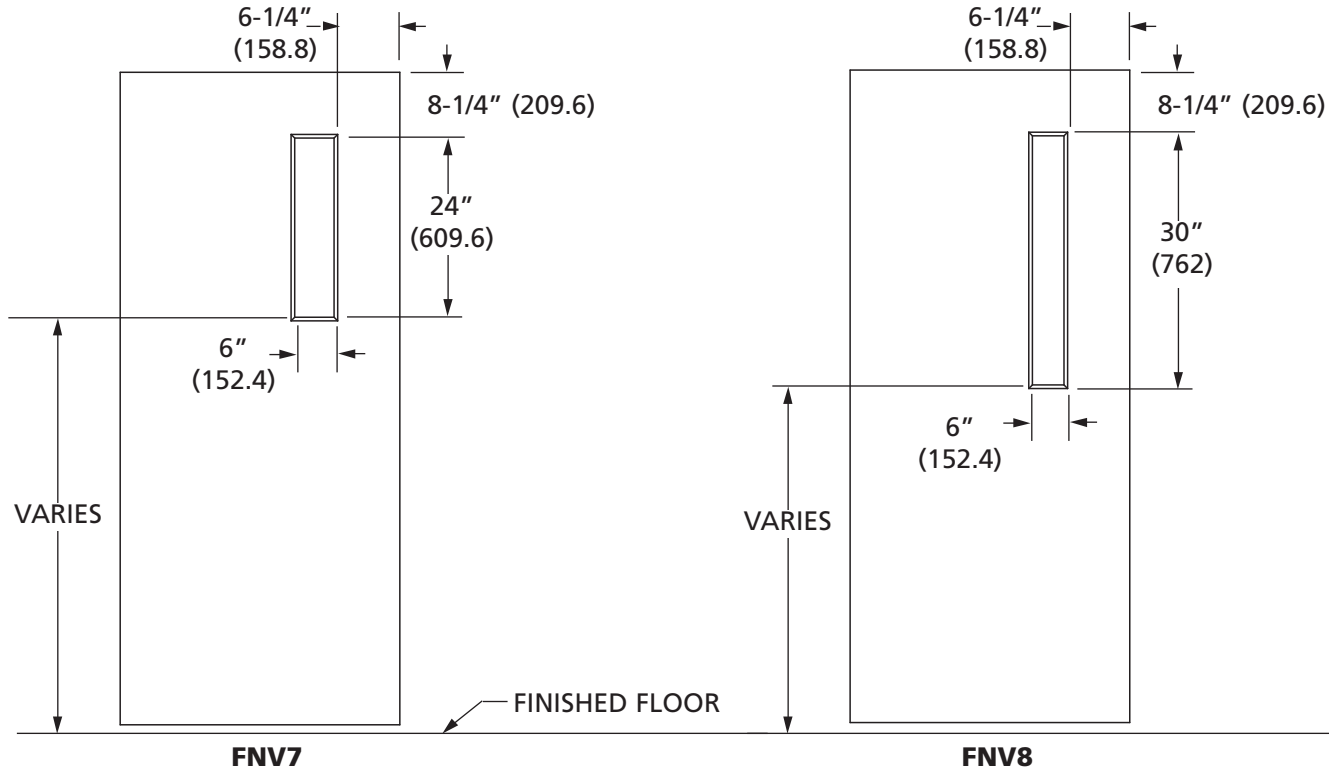

**STANDARD LOCATIONS FOR
DOORS 7'2" (2184.4) AND UNDER**

February, 2009

Type 9 & 10 Window Moulding

ASSA ABLOY, the global leader in door opening solutions

Ⓛ

STANDARD LOCATIONS FOR DOORS 7'2" (2184.4) AND UNDER

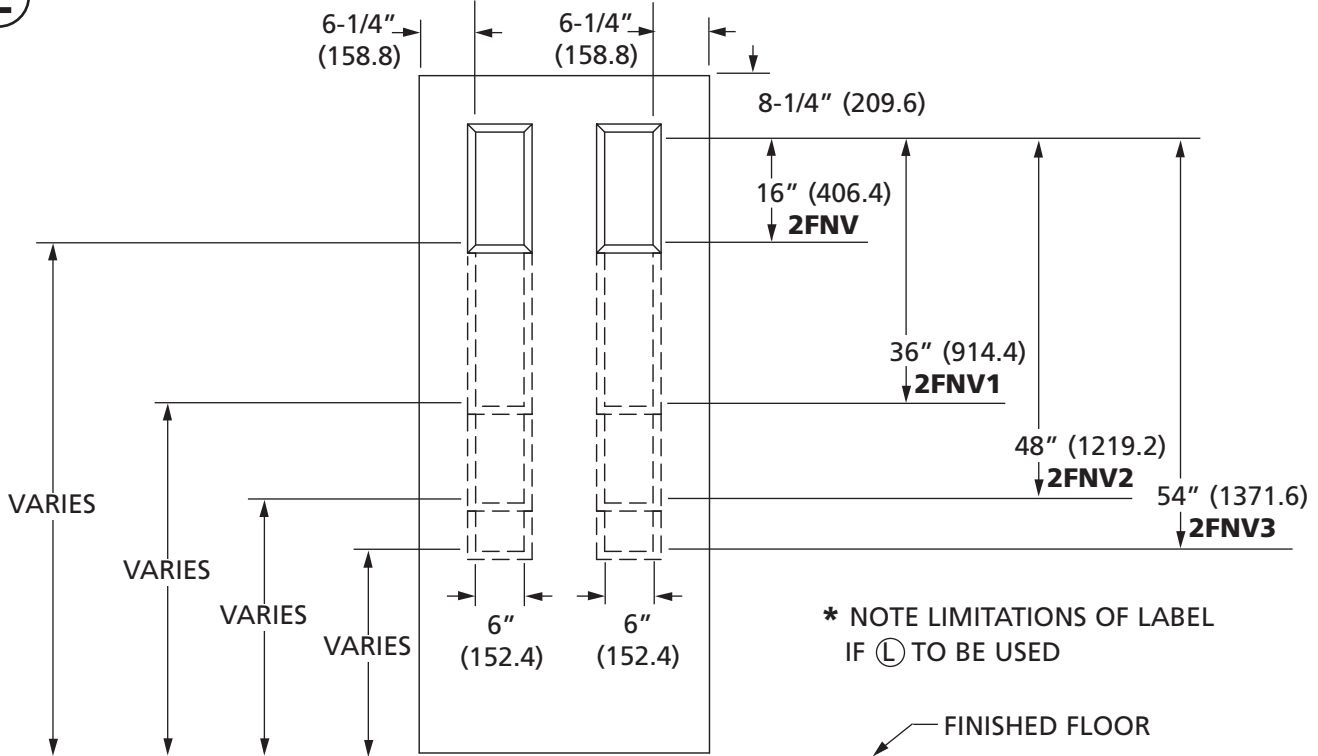

STANDARD LOCATIONS FOR DOORS OVER 7'2" (2184.4)

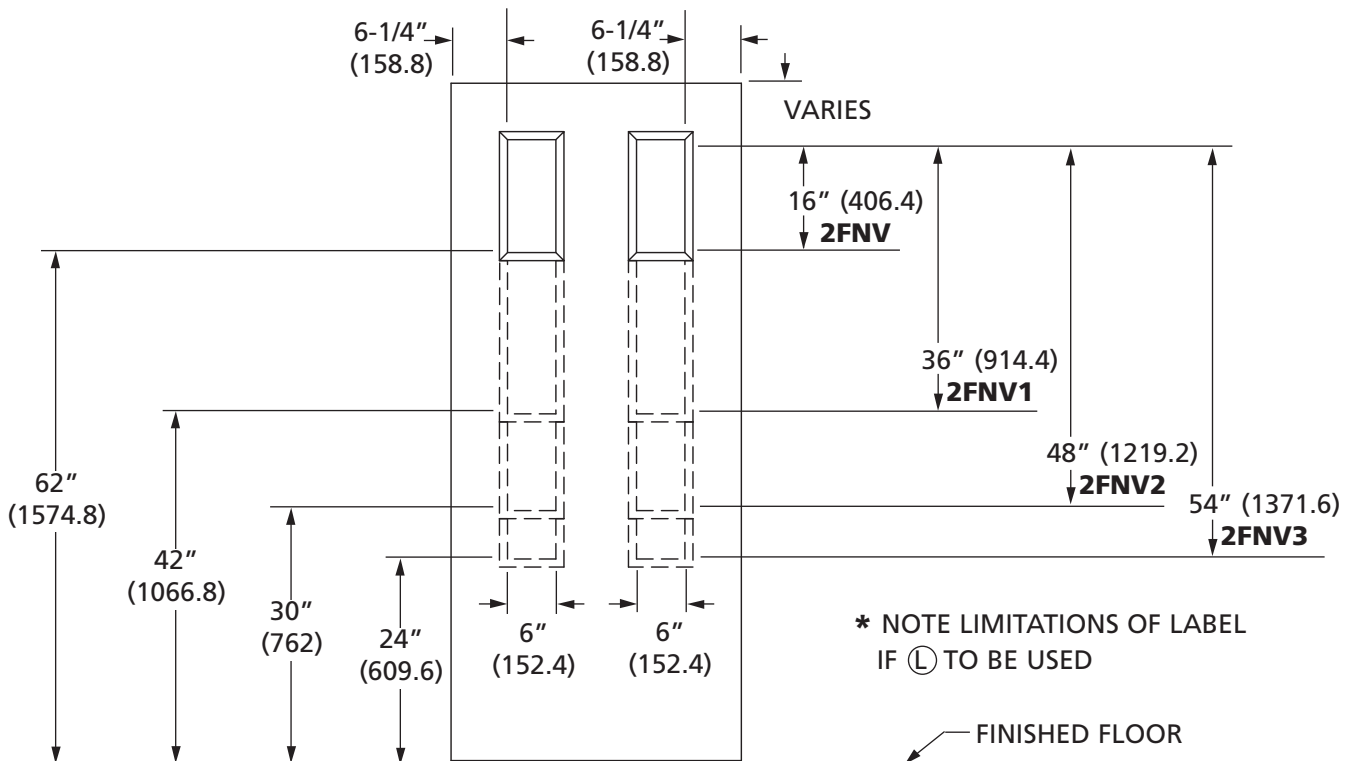

Type 9 & 10 Window Moulding

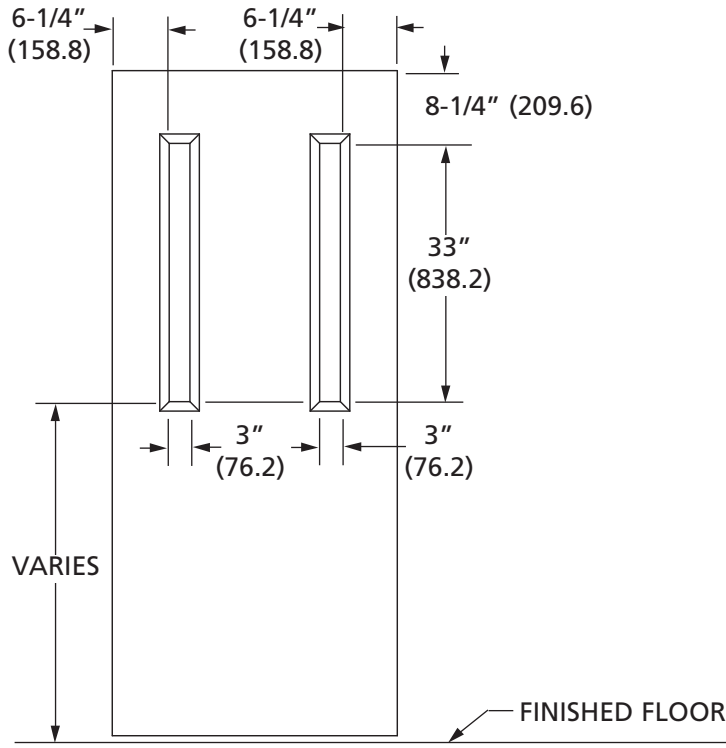

*** 2FNV4**

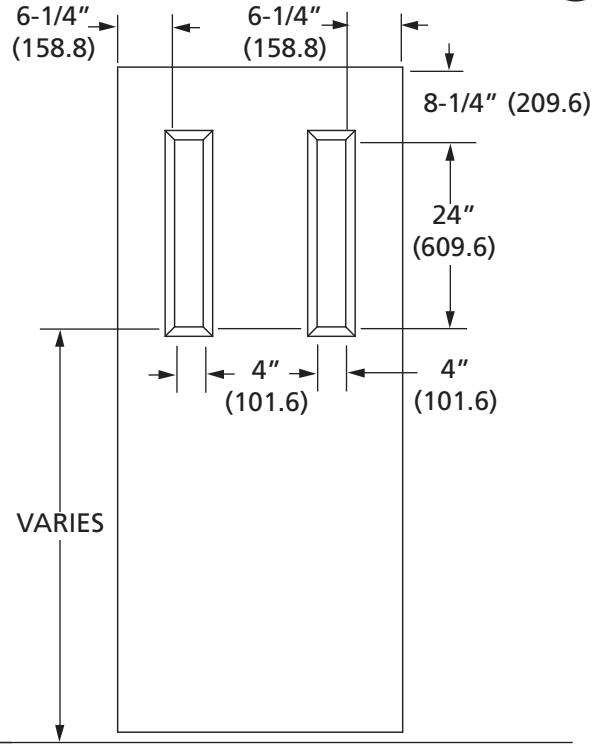

*** 2FNV5**

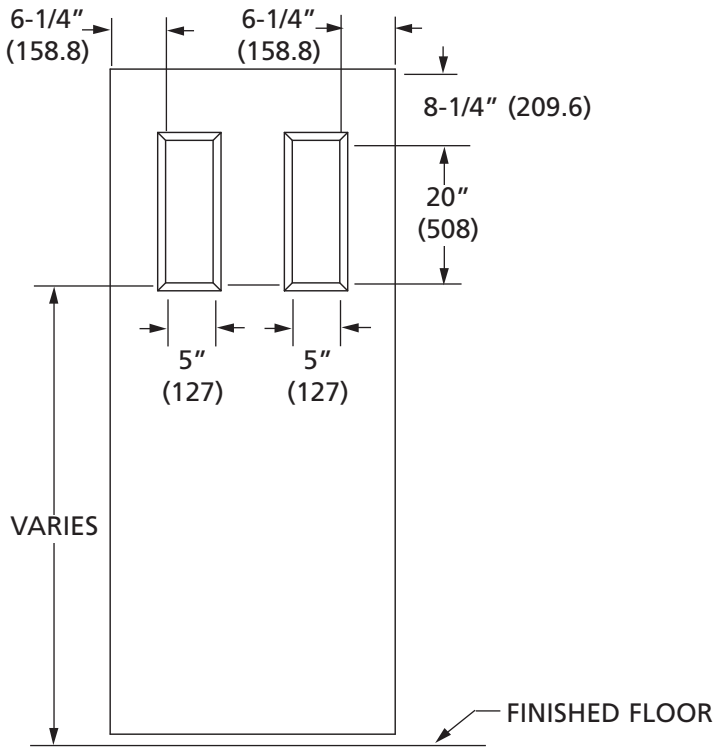

*** 2FNV6**

*** MINIMUM 6" (152.4) STILES
TO BE LABEL APPROVED**

**STANDARD LOCATIONS FOR
DOORS 7'2" (2184.4) AND UNDER**

February, 2009

ASSA ABLOY, the global leader in door opening solutions

Type 9 & 10 Window Moulding

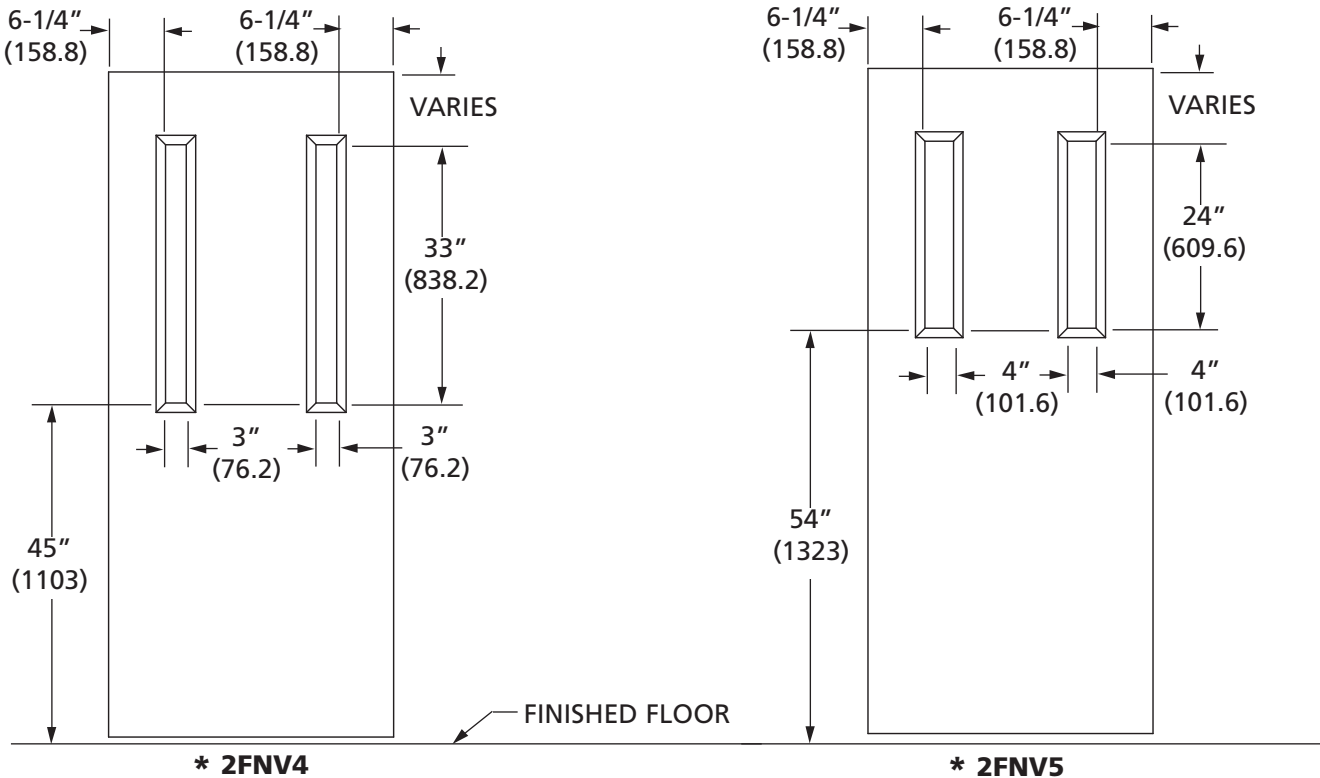

* 2FNV4

* 2FNV5

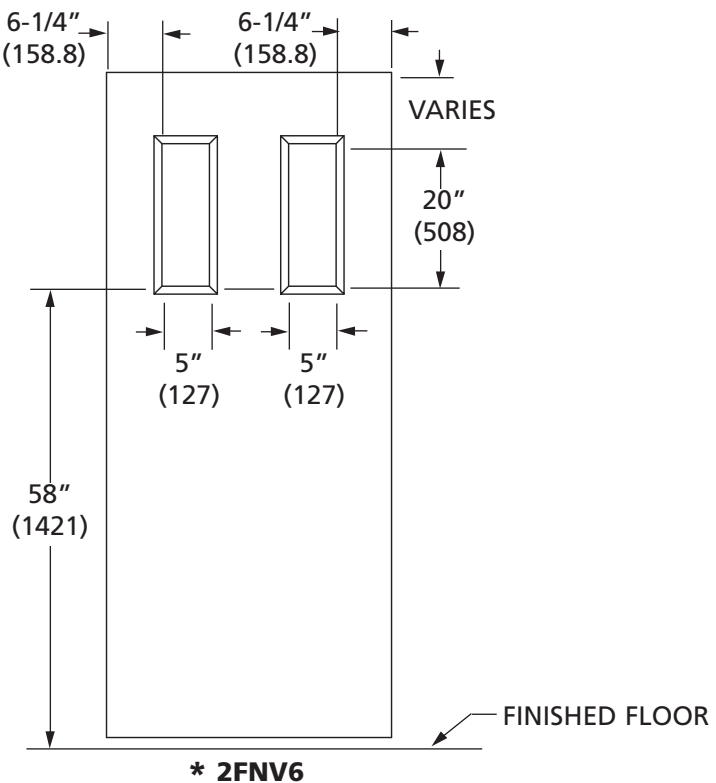

* 2FNV6

* MINIMUM 6" (152.4) STILES TO BE LABEL APPROVED

STANDARD LOCATIONS FOR DOORS OVER 7'2"

Type 9 & 10 Window Moulding

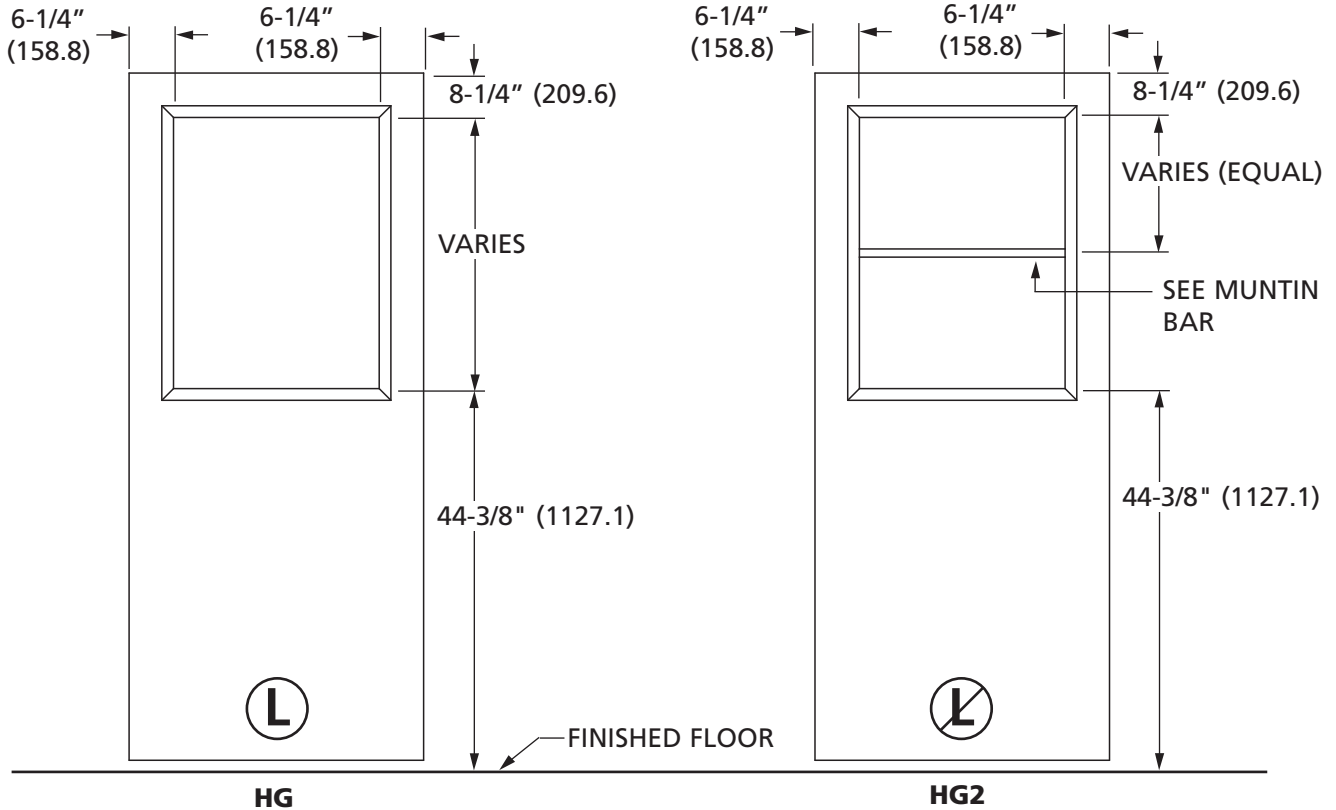

DOOR WIDTH	VISIBLE WIDTH	DOOR HEIGHT	VISIBLE HEIGHT
2'0" (609.6)	11-5/16" (287.3)		
2'4" (711.2)	15-5/16" (388.9)		
2'6" (762)	17-5/16" (439.7)	6'8" (2032)	27-1/4" (692.1)
2'8" (812.8)	19-5/16" (490.5)		
2'10" (863.6)	21-5/16" (541.3)		
3'0" (914.4)	23-5/16" (592.1)	7'0" (2133.6)	31-1/4" (793.8)
3'4" (1016)	27-5/16" (693.7)		
3'6" (1066.8)	29-5/16" (744.5)		
3'8" (1117.6)	31-5/16" (795.3)	7'2" (2184.4)	33-1/4" (844.6)
3'10" (1168.4)	33-5/16" (846.1)		
4'0" (1219.2)	35-5/16" (896.9)		

DOOR WIDTH	VISIBLE WIDTH	DOOR HEIGHT	VISIBLE HEIGHT
2'0" (609.6)	11-5/16" (287.3)		
2'4" (711.2)	15-5/16" (388.9)		
2'6" (762)	17-5/16" (439.7)	6'8" (2032)	13-3/16" (335)
2'8" (812.8)	19-5/16" (490.5)		
2'10" (863.6)	21-5/16" (541.3)		
3'0" (914.4)	23-5/16" (592.1)	7'0" (2133.6)	15-3/16" (385.8)
3'4" (1016)	27-5/16" (693.7)		
3'6" (1066.8)	29-5/16" (744.5)		
3'8" (1117.6)	31-5/16" (795.3)	7'2" (2184.4)	16-3/16" (411.2)
3'10" (1168.4)	33-5/16" (846.1)		
4'0" (1219.2)	35-5/16" (896.9)		

NOTE: FOR DOORS OVER 7'2" (2184.4) UP TO AND INCLUDING 8'0" (2438.4) STILE AND RAIL DIMENSIONS SHOWN ARE MAINTAINED. OVER 8'0" (2438.4) A MAXIMUM 44" (1117.6) VISIBLE HEIGHT IS AVAILABLE ON HG TYPE DOORS. OVER 44" (1117.6) VISIBLE HEIGHT IS CONSIDERED A FG DOOR. ALWAYS INDICATE LOCATION OF LIGHT ON DOOR FACE WHEN ORDERING DOORS OVER 8'0" (2438.4).

DOOR TECHNICAL DATA

February, 2009

ASSA ABLOY, the global leader in door opening solutions

Type 9 & 10 Window Moulding

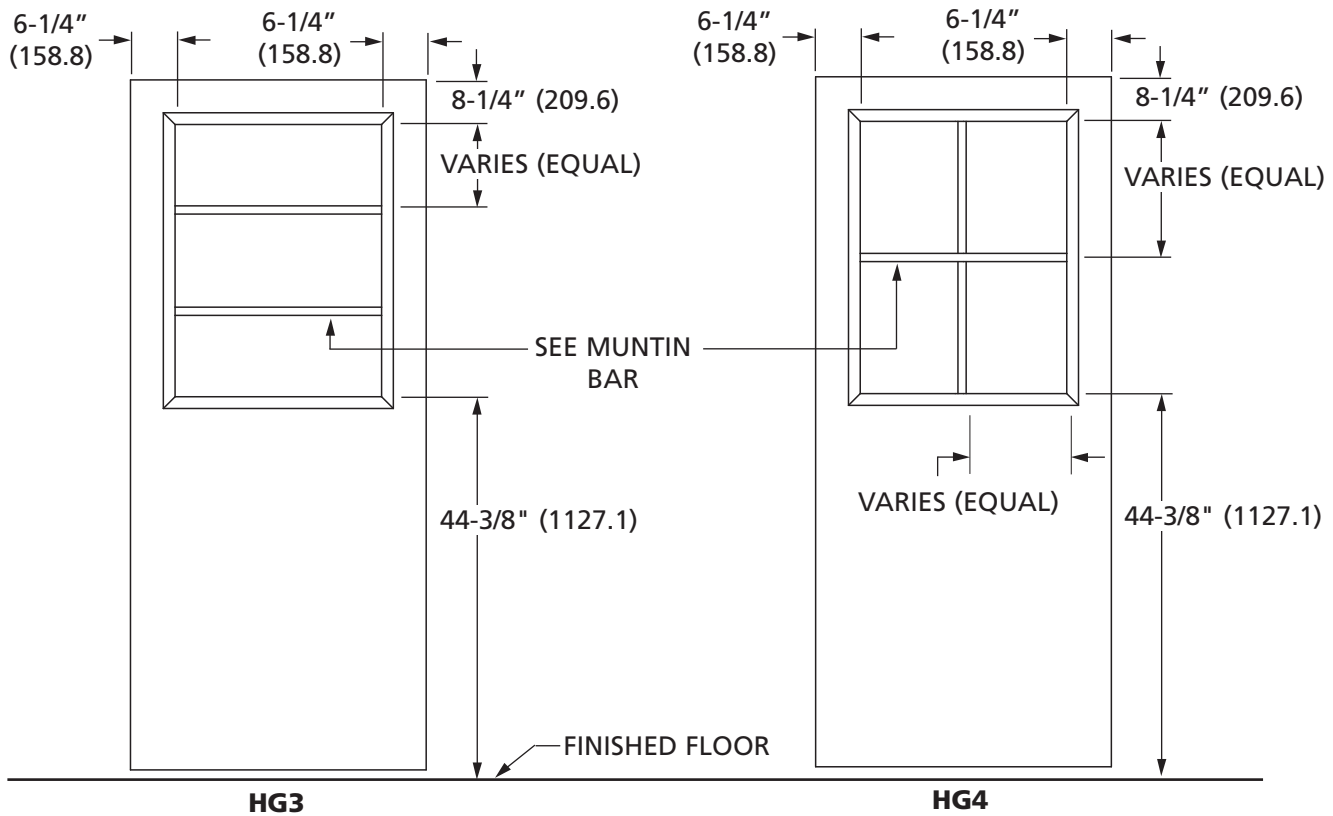

DOOR WIDTH	VISIBLE WIDTH	DOOR HEIGHT	VISIBLE HEIGHT	DOOR WIDTH	VISIBLE WIDTH	DOOR HEIGHT	VISIBLE HEIGHT
2'0" (609.6)	11-5/16" (287.3)			2'0" (609.6)	5-7/32" (132.6)		
2'4" (711.2)	15-5/16" (388.9)			2'4" (711.2)	7-7/32" (183.4)		
2'6" (762)	17-5/16" (439.7)	6'8" (2032)	8-1/2" (215.9)	2'6" (762)	8-7/32" (208.8)	6'8" (2032)	13-3/16" (335)
2'8" (812.8)	19-5/16" (490.5)			2'8" (812.8)	9-7/32" (234.2)		
2'10" (863.6)	21-5/16" (541.3)			2'10" (863.6)	10-7/32" (259.6)		
3'0" (914.4)	23-5/16" (592.1)	7'0" (2133.6)	9-53/64" (249.6)	3'0" (914.4)	11-7/32" (285)	7'0" (2133.6)	15-3/16" (385.8)
3'4" (1016)	27-5/16" (693.7)			3'4" (1016)	13-7/32" (335.8)		
3'6" (1066.8)	29-5/16" (744.5)			3'6" (1066.8)	14-7/32" (361.2)		
3'8" (1117.6)	31-5/16" (795.3)	7'2" (2184.4)	10-1/2" (266.7)	3'8" (1117.6)	15-7/32" (386.6)	7'2" (2184.4)	16-3/16" (411.16)
3'10" (1168.4)	33-5/16" (846.1)			3'10" (1168.4)	16-7/32" (412)		
4'0" (1219.2)	35-5/16" (896.9)			4'0" (1219.2)	17-7/32" (437.4)		

NOTE: FOR DOORS OVER 7'2" (2184.4) UP TO AND INCLUDING 8'0" (2438.4) STILE AND RAIL DIMENSIONS SHOWN ARE MAINTAINED. OVER 8'0" (2438.4) A MAXIMUM 44" (1117.6) VISIBLE HEIGHT IS AVAILABLE ON HG TYPE DOORS. OVER 44" (1117.6) VISIBLE HEIGHT IS CONSIDERED A FG DOOR. ALWAYS INDICATE LOCATION OF LIGHT ON DOOR FACE WHEN ORDERING DOORS OVER 8'0" (2438.4).

ASSA ABLOY, the global leader in door opening solutions

February, 2009

Type 9 & 10 Window Moulding

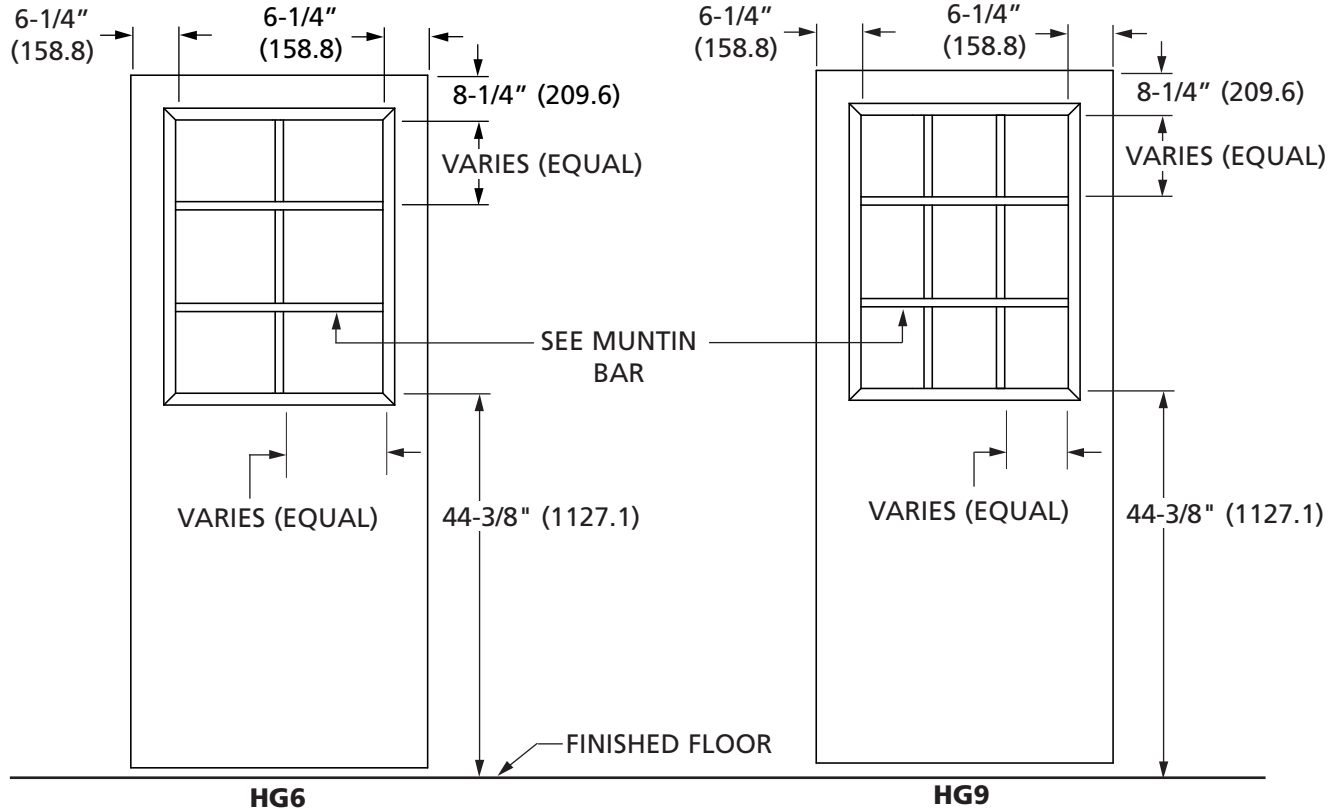

DOOR WIDTH	VISIBLE WIDTH	DOOR HEIGHT	VISIBLE HEIGHT
2'0" (609.6)	5-7/32" (132.6)		
2'4" (711.2)	7-7/32" (183.4)		
2'6" (762)	8-7/32" (208.8)	6'8" (2032)	8-1/2" (215.9)
2'8" (812.8)	9-7/32" (234.2)		
2'10" (863.6)	10-7/32" (259.6)		
3'0" (914.4)	11-7/32" (285)	7'0" (2133.6)	9-53/64" (250)
3'4" (1016)	13-7/32" (335.8)		
3'6" (1066.8)	14-7/32" (361.2)		
3'8" (1117.6)	15-7/32" (386.6)	7'2" (2184.4)	10-1/2" (266.7)
3'10" (1168.4)	16-7/32" (412)		
4'0" (1219.2)	17-7/32" (437.4)		

DOOR WIDTH	VISIBLE WIDTH	DOOR HEIGHT	VISIBLE HEIGHT
2'0" (609.6)	3-9/64" (79.8)		
2'4" (711.2)	4-29/64" (113.1)		
2'6" (762)	5-9/64" (130.6)	6'8" (2032)	8-1/2" (215.9)
2'8" (812.8)	5-53/64" (148)		
2'10" (863.6)	6-29/64" (164)		
3'0" (914.4)	7-9/64" (181.4)	7'0" (2133.6)	9-53/64" (249.6)
3'4" (1016)	8-29/64" (214.7)		
3'6" (1066.8)	9-9/64" (232.2)		
3'8" (1117.6)	5-53/64" (148)	7'2" (2184.4)	10-1/2" (266.7)
3'10" (1168.4)	10-29/64" (265.5)		
4'0" (1219.2)	11-9/64" (283)		

NOTE: FOR DOORS OVER 7'2" (2184.4) UP TO AND INCLUDING 8'0" (2438.4) STILE AND RAIL DIMENSIONS SHOWN ARE MAINTAINED. OVER 8'0" (2438.4) A MAXIMUM 44" (1117.6) VISIBLE HEIGHT IS AVAILABLE ON HG TYPE DOORS. OVER 44" (1117.6) VISIBLE HEIGHT IS CONSIDERED A FG DOOR. ALWAYS INDICATE LOCATION OF LIGHT ON DOOR FACE WHEN ORDERING DOORS OVER 8'0" (2438.4).

DOOR TECHNICAL DATA

February, 2009

ASSA ABLOY, the global leader in door opening solutions

Type 9 & 10 Window Moulding

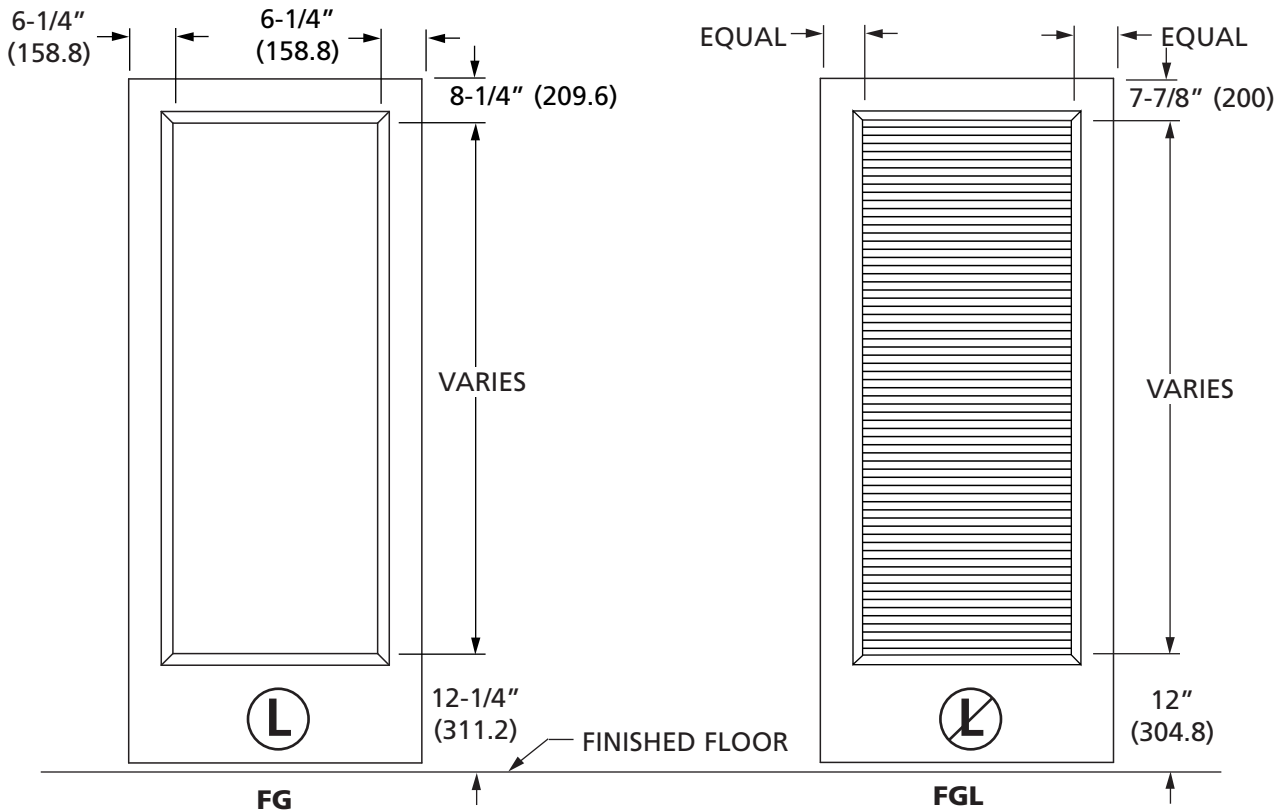

DOOR WIDTH	VISIBLE WIDTH	DOOR HEIGHT	VISIBLE HEIGHT
2'0" (609.6)	11-5/16" (287.3)		
2'4" (711.2)	15-5/16" (388.9)		
2'6" (762)	17-5/16" (439.7)	6'8" (2032)	59-3/8" (1508.1)
2'8" (812.8)	19-5/16" (490.5)		
2'10" (863.6)	21-5/16" (541.3)		
3'0" (914.4)	23-5/16" (592.1)	7'0" (2133.6)	63-3/8" (1609.7)
3'4" (1016)	27-5/16" (693.7)		
3'6" (1066.8)	29-5/16" (744.5)		
3'8" (1117.6)	31-5/16" (795.3)	7'2" (2184.4)	65-3/8" (1660.5)
3'10" (1168.4)	33-5/16" (846.1)		
4'0" (1219.2)	35-5/16" (896.9)		

DOOR WIDTH	VISIBLE WIDTH	DOOR HEIGHT	VISIBLE HEIGHT
2'0" (609.6)	12" (304.8)		
2'4" (711.2)	16" (406.4)		
2'6" (762)	18" (457.2)	6'8" (2032)	60" (1524)
2'8" (812.8)	20" (508)		
2'10" (863.6)	22" (558.8)		
3'0" (914.4)	24" (609.6)	7'0" (2133.6)	64" (1625.6)
3'4" (1016)	28" (711.6)		
3'6" (1066.8)	30" (762)		
3'8" (1117.6)	32" (812.8)	7'2" (2184.4)	66" (1676.4)
3'10" (1168.4)	34" (863.6)		
4'0" (1219.2)	36" (914.4)		

NOTE: FOR DOORS OVER 7'2" (2184.4) UP TO AND INCLUDING 8'0" (2438.4) STILE AND RAIL DIMENSIONS SHOWN ARE MAINTAINED. OVER 8'0" (2438.4) A MAXIMUM 44" (1117.6) VISIBLE HEIGHT IS AVAILABLE ON HG TYPE DOORS. OVER 44" (1117.6) VISIBLE HEIGHT IS CONSIDERED A FG DOOR. ALWAYS INDICATE LOCATION OF LIGHT ON DOOR FACE WHEN ORDERING DOORS OVER 8'0" (2438.4).

ASSA ABLOY, the global leader in door opening solutions

February, 2009

Type 9 & 10 Window Moulding

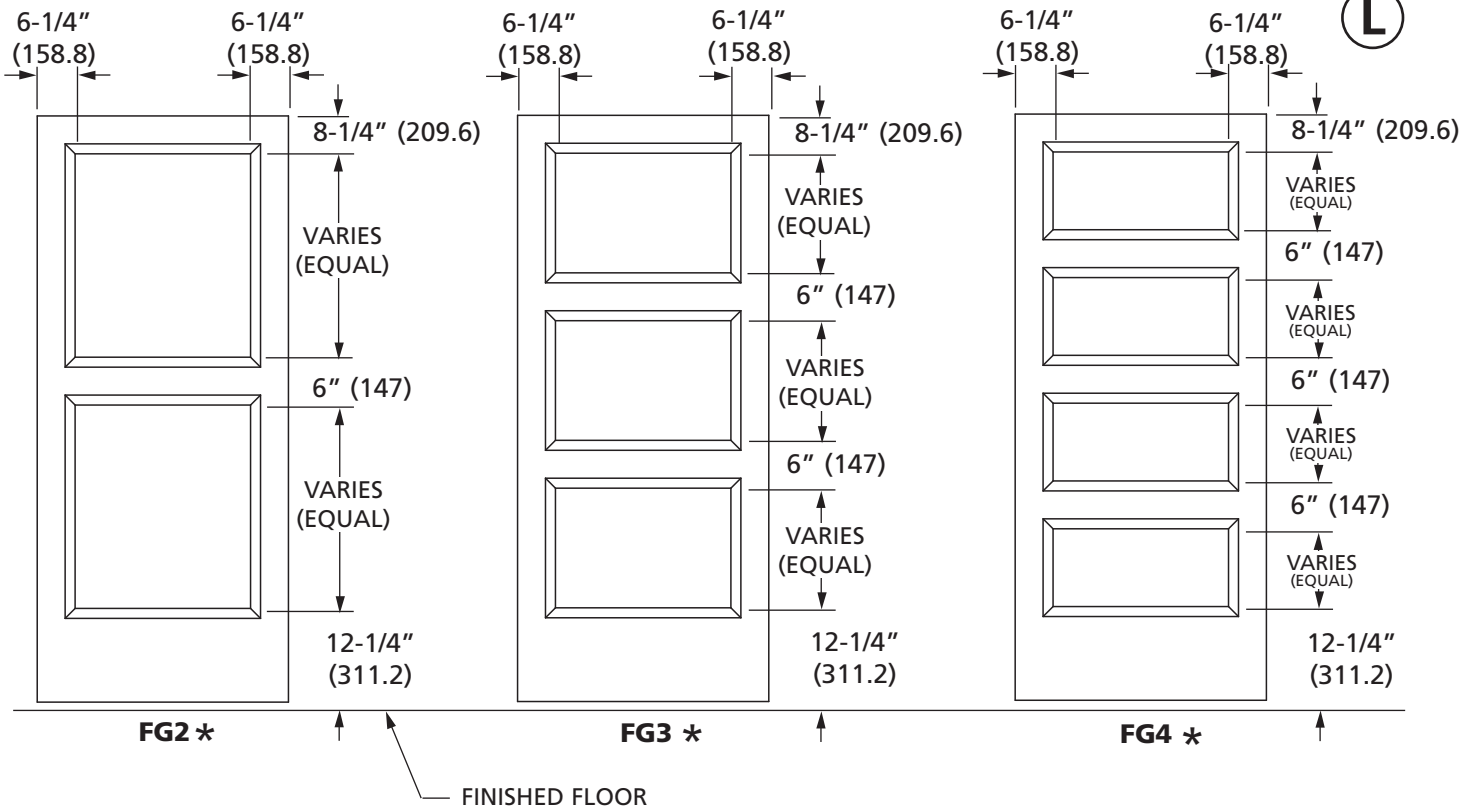

*** NOTE: A MINIMUM 6" STILE AND 6" RAIL IS REQUIRED FOR FIRE LABEL LISTED DOOR)**

FG2		FG3		FG4			
DOOR WIDTH	VISIBLE WIDTH	DOOR HEIGHT	VISIBLE HEIGHT	DOOR HEIGHT	VISIBLE HEIGHT	DOOR HEIGHT	VISIBLE HEIGHT
2'0" (609.6)	11-5/16" (287.3)						
2'4" (711.2)	15-5/16" (388.9)						
2'6" (762)	17-5/16" (439.7)	6'8" (2032)	26-11/16" (653.8)	6'8" (2032)	15-13/16" (401.6)	6'8" (2032)	10-3/8" (263.5)
2'8" (812.8)	19-5/16" (490.5)						
2'10" (863.6)	21-5/16" (541.3)						
3'0" (914.4)	23-5/16" (592.1)	7'0" (2133.6)	28-11/16" (702.8)	7'0" (2133.6)	17-1/8" (435)	7'0" (2133.6)	11-3/8" (288.9)
3'4" (1016)	27-5/16" (693.7)						
3'6" (1066.8)	29-5/16" (744.5)						
3'8" (1117.6)	31-5/16" (795.3)	7'2" (2184.4)	29-11/16" (727.3)	7'2" (2184.4)	15-13/16" (401.6)	7'2" (2184.4)	11-7/8" (301.6)
3'10" (1168.4)	33-5/16" (846.1)						
4'0" (1219.2)	35-5/16" (896.9)						

NOTE: FOR DOORS OVER 7'2" (2184.4) UP TO AND INCLUDING 8'0" (2438.4) STILE AND RAIL DIMENSIONS SHOWN ARE MAINTAINED. ALWAYS INDICATE LOCATION OF LIGHT ON DOOR FACE WHEN ORDERING DOORS OVER 8'0" (2438.4).

DOOR TECHNICAL DATA

February, 2009

ASSA ABLOY, the global leader
in door opening solutions

Type 9 & 10 Window Moulding

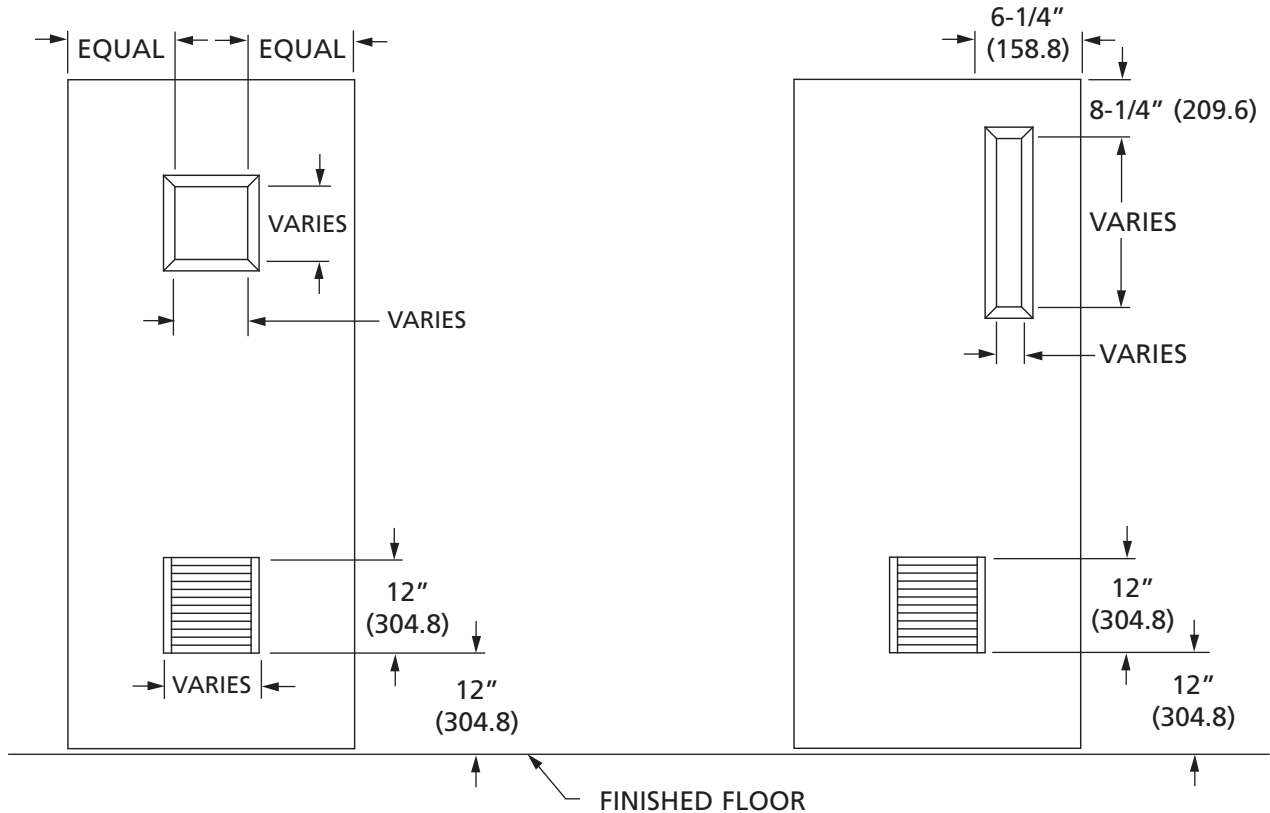

FVL

FV = FULL VISION STANDARDS
L = LOUVER STANDARDS

FNVL

FNV = FULL NARROW VISION STANDARDS
L = LOUVER STANDARDS

EXAMPLE: FV1L2
12" X 12" (305 X 305) FULL VISION LITE ←
18" X 12" (457 X 305) LOUVER ←

EXAMPLE: FNVL2
6" X 36" (152 X 914) NARROW VISION LITE ←
18" X 12" (457 X 305) LOUVER ←

PROVIDE CUTOUT ONLY SIZE FOR LOUVERS

Type 9 & 10 Window Moulding

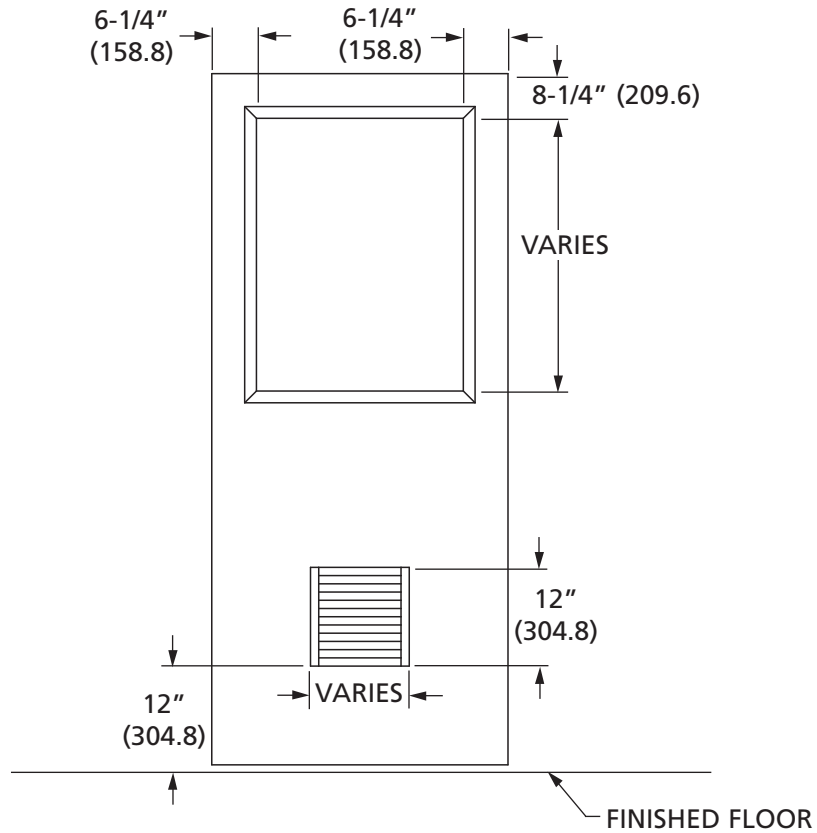

HGL

HG = HALF GLASS STANDARDS

L = LOUVER STANDARDS

EXAMPLE: HG L2
WINDOW PANE-HALF GLASS ←
18" X 12" (457 X 305) LOUVER ←

PROVIDE CUTOUT ONLY SIZE FOR LOUVERS

DOOR TECHNICAL DATA

February, 2009

ASSA ABLOY, the global leader in door opening solutions

Type 9 & 10 Window Moulding

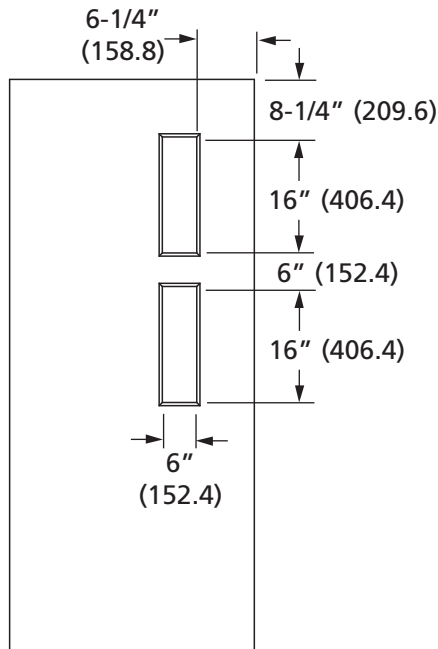

F2NV

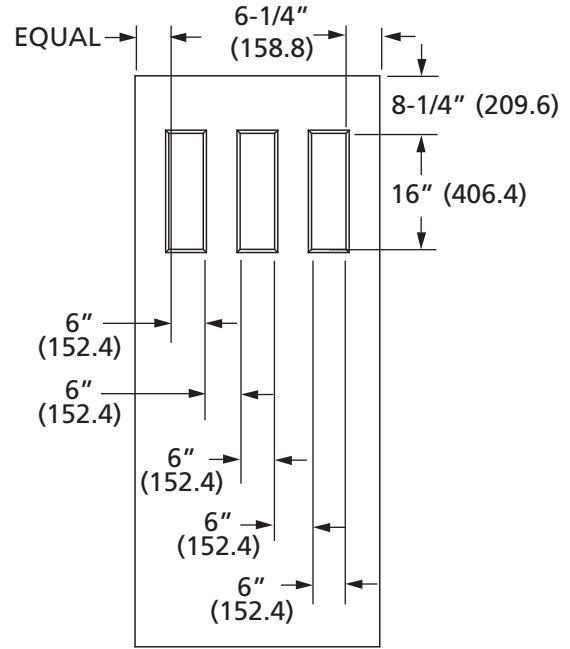

3FNV

DOOR WIDTH FOR 3FNV MUST BE AT LEAST 3'7" (1092.2) WIDE!

* **NOTE:** MINIMUM 6" STILES TO BE FIRE LABEL LISTED.

Face Type Locations FD, FDFV

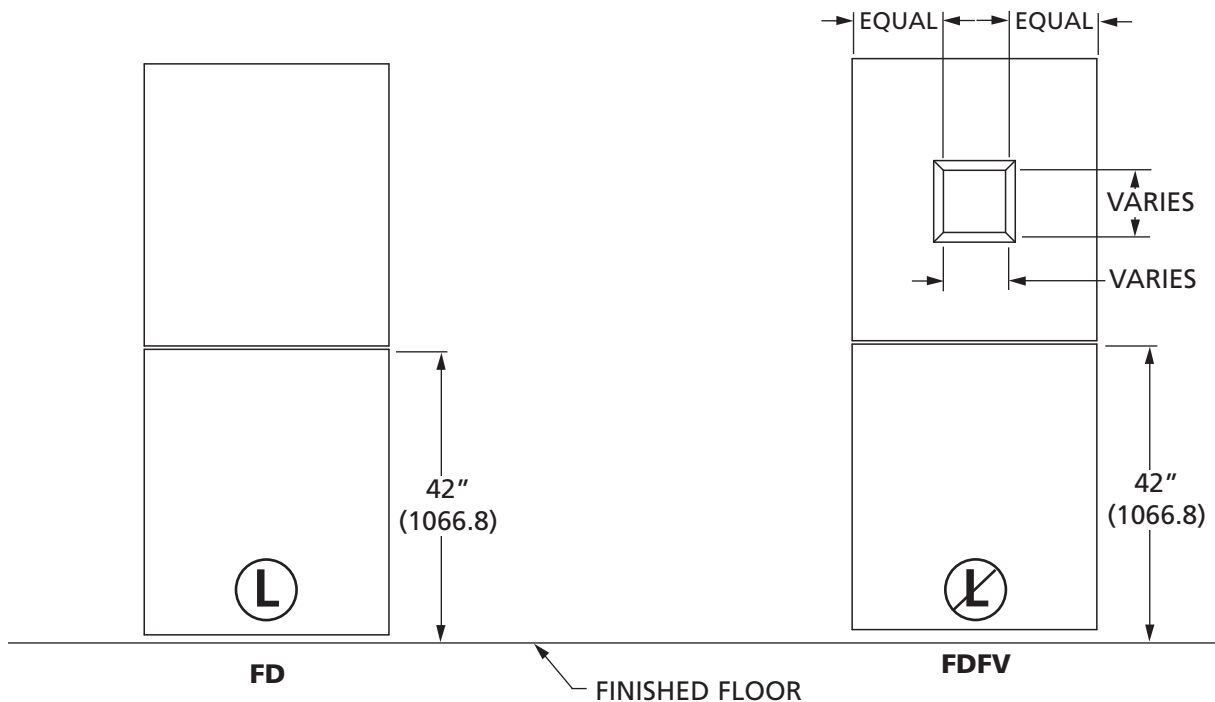

FD



FDFV

FINISHED FLOOR

FDFV	10" (254) X 10" (254)
FDFV1	12" (304.8) X 12" (304.8)

Type 9 & 10 Window Moulding

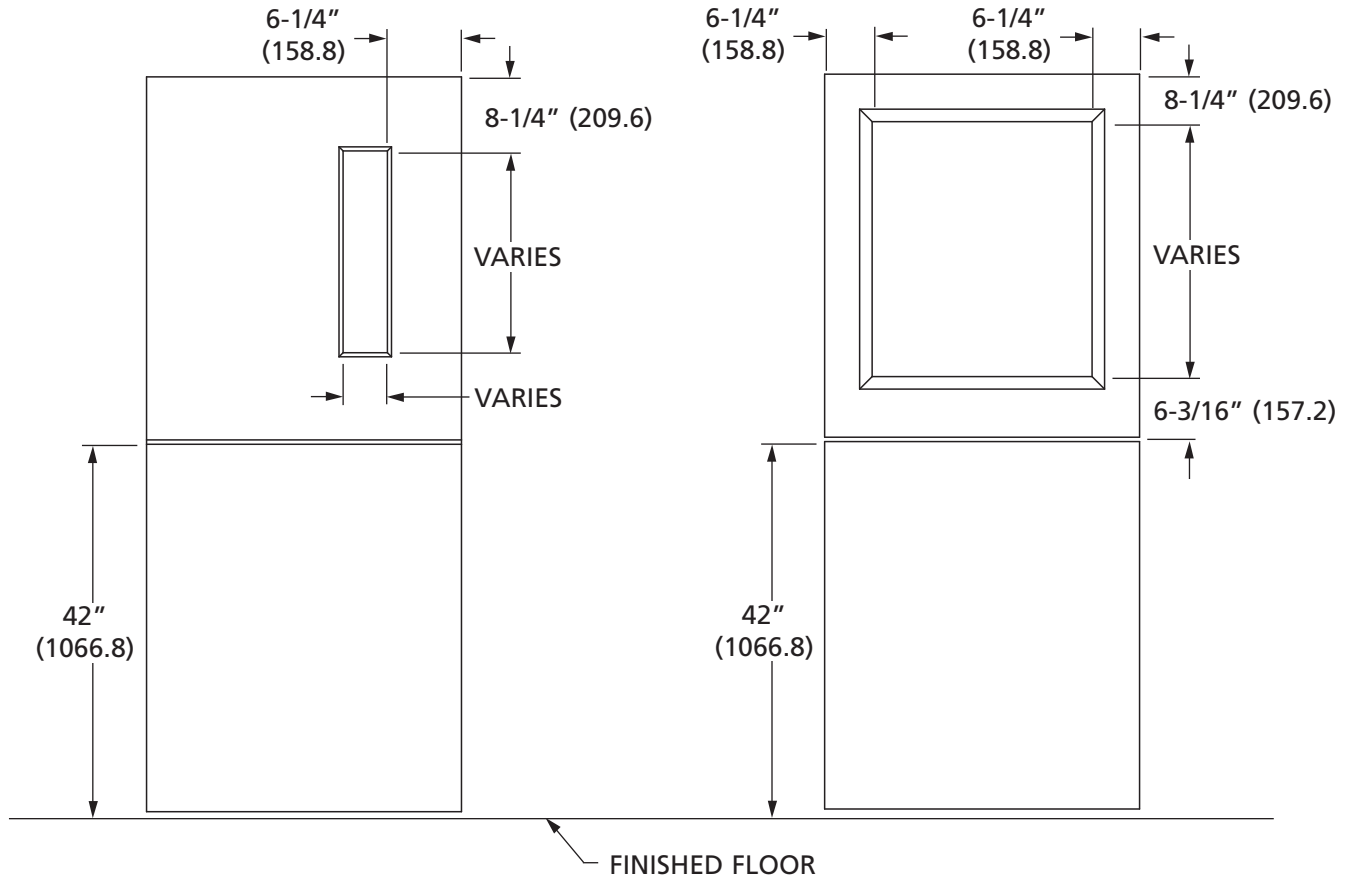

FDFNV

FD = FLUSH DUTCH
FNV = FULL NARROW VISION STANDARDS

FDHG

FD = FLUSH DUTCH
HG = HALF GLASS STANDARDS

EXAMPLE: **FDFNV1**
FLUSH DUTCH ←
6" X 36" (152 X 914) NARROW VISION LITE ←

EXAMPLE: **FDHG**
FLUSH DUTCH ←
(3) WINDOW PANE-HALF GLASS ←

February, 2009

ASSA ABLOY, the global leader in door opening solutions

Type 9 & 10 Window Moulding

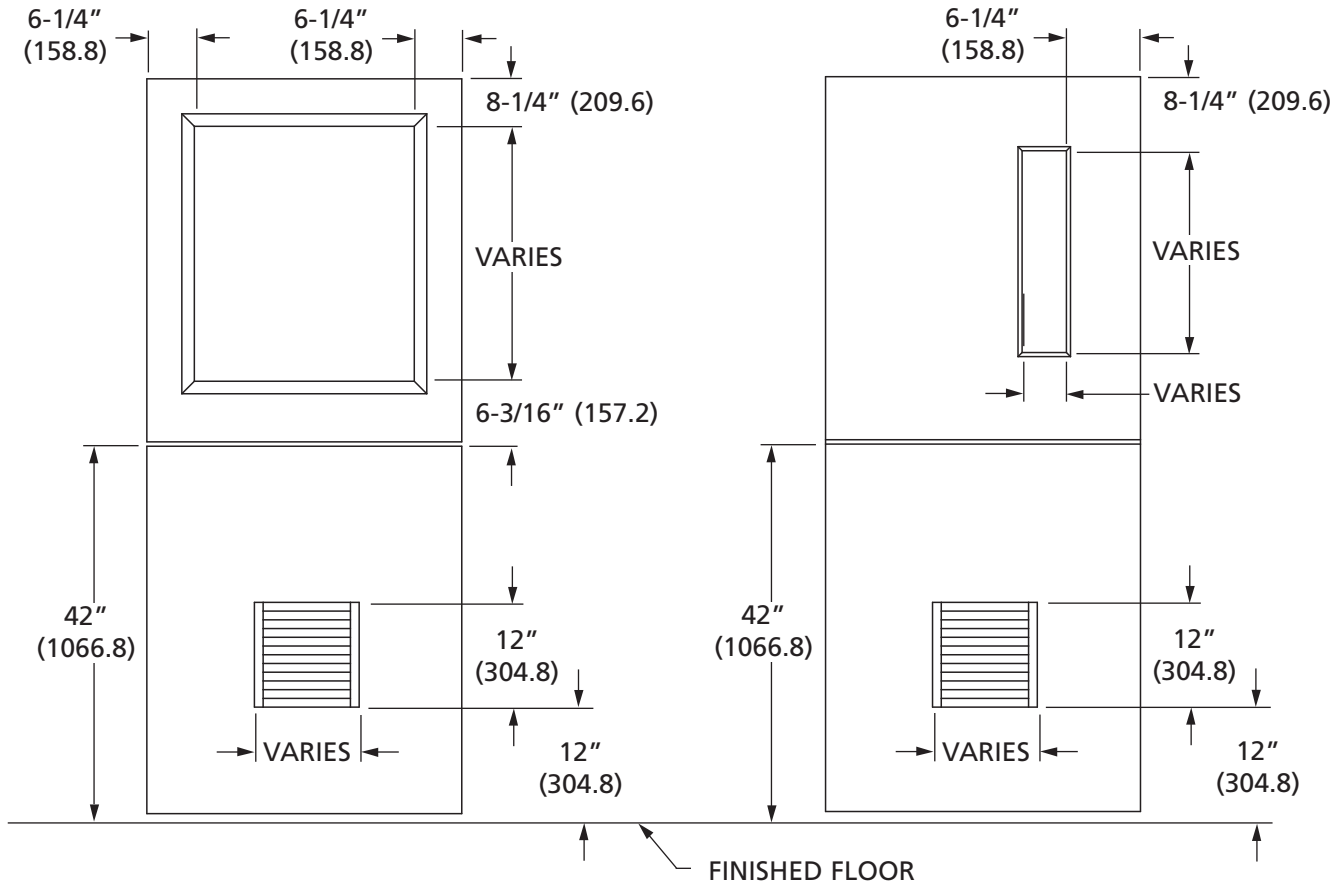

FDHGL

- FD = FLUSH DUTCH
- HG = HALF GLASS STANDARDS
- L = LOUVER STANDARDS

FDFNVL

- FD = FLUSH DUTCH
- FNV = FULL NARROW VISION STANDARDS
- L = LOUVER STANDARDS

EXAMPLE: **FDHG3L2**
 FLUSH DUTCH
 (3) WINDOW PANE-HALF GLASS
 18" X 12" (457 X 305) LOUVER

EXAMPLE: **FDFNV1L2**
 FLUSH DUTCH
 6" X 36" (152 X 914) NARROW VISION LITE
 18" X 12" (457 X 305) LOUVER

PROVIDE CUTOUT ONLY SIZE FOR LOUVERS

Type 9 & 10 Window Moulding

Type 9 & 10 Kits

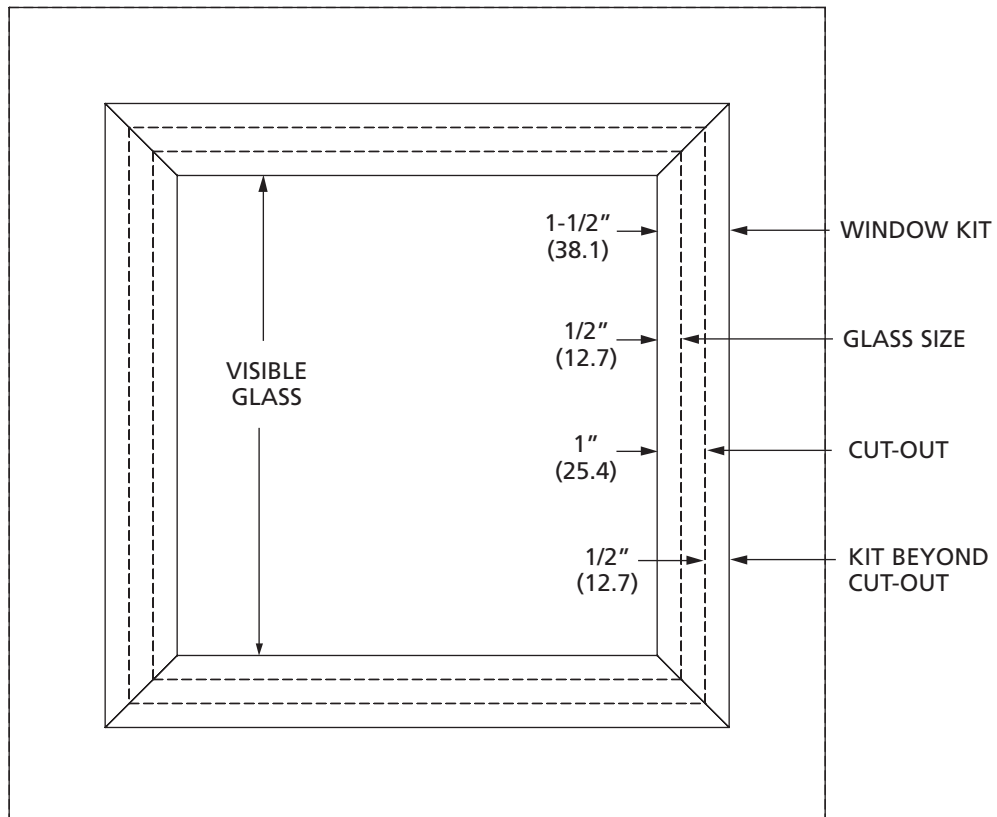
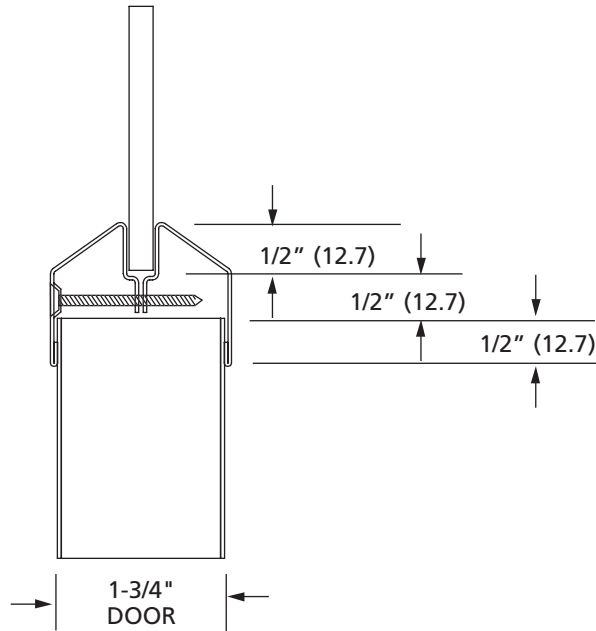

February, 2009

ASSA ABLOY, the global leader
in door opening solutions

Type 9 & 10 Window Moulding

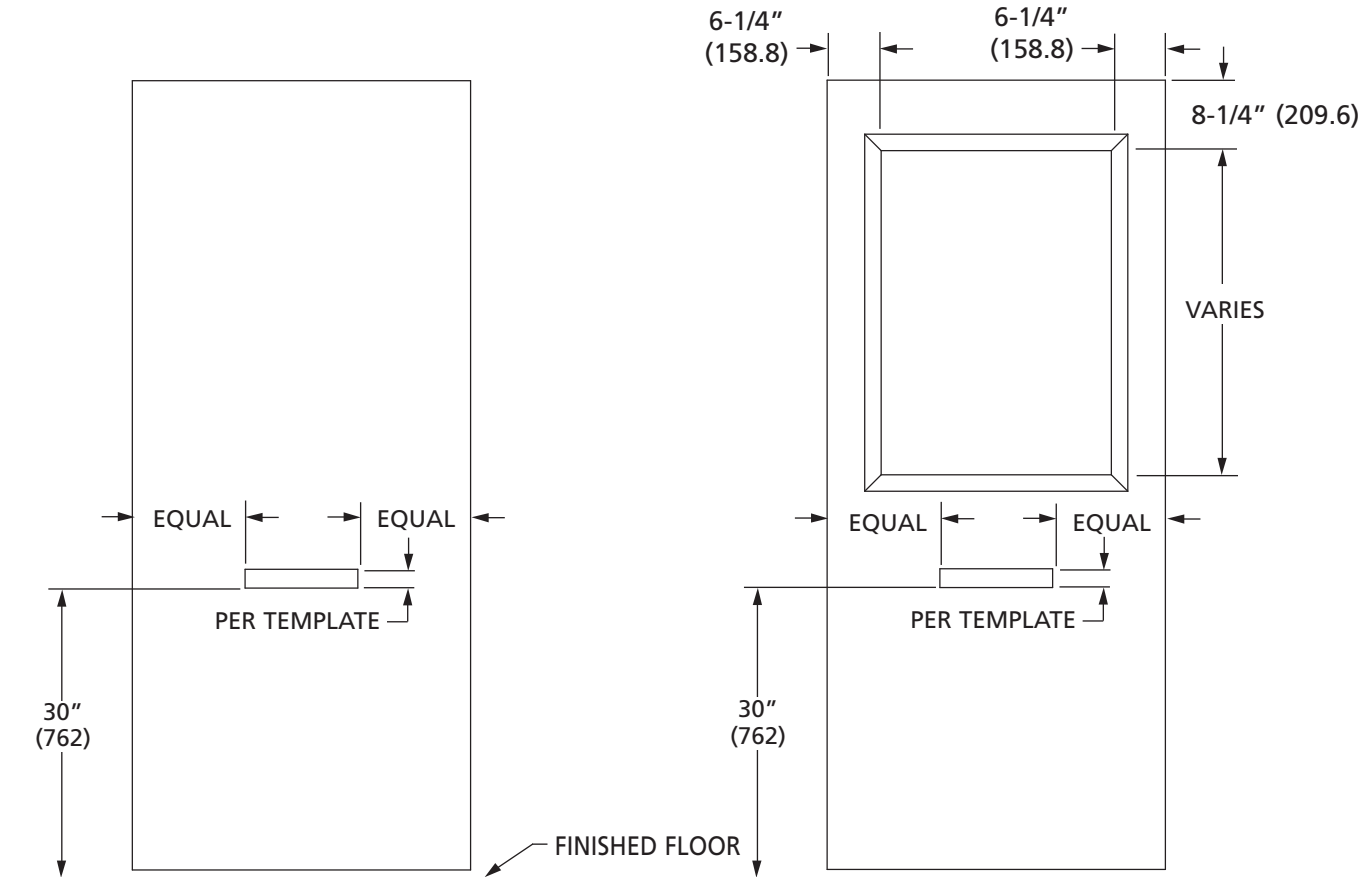

FMS

FMS = FLUSH MAIL SLOT

HGMS

HG = HALF GLASS STANDARDS

MS = MAIL SLOT

EXAMPLE: HG3MS
 (3) WINDOW PANE-HALF GLASS ←
 MAIL SLOT ←

Type 9 & 10 Window Moulding

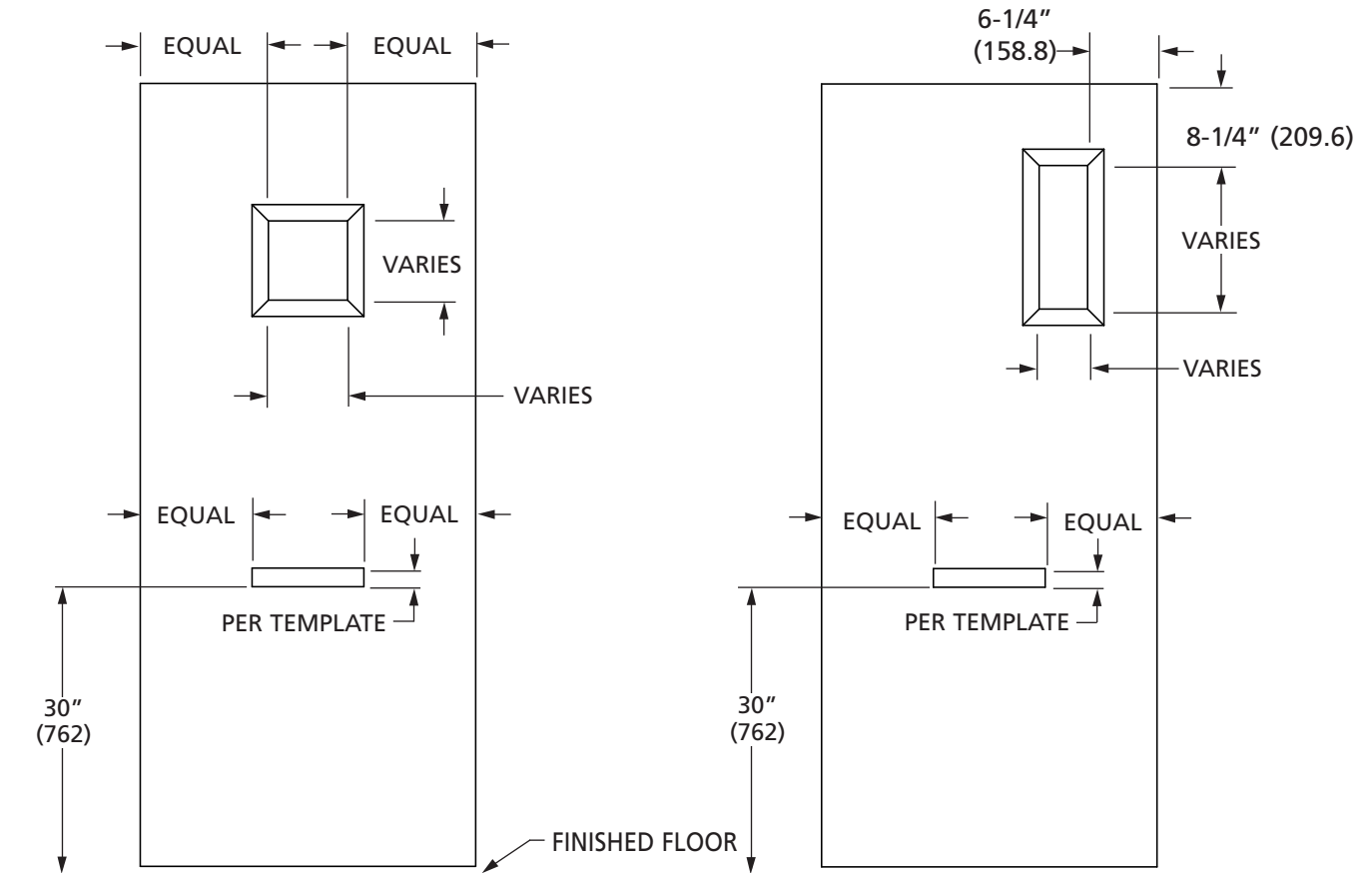

FVMS

FV = FULL VISION STANDARDS
MS = MAIL SLOT

FNVMS

FNV = FULL NARROW VISION STANDARDS
MS = MAIL SLOT

FVMS	10" (254) X 10" (254)
FV1MS	12" (304.8) X 12" (304.8)

EXAMPLE: FNV1MS
6" X 36" (152 X 914) NARROW VISION LITE ←
MAIL SLOT ←

DOOR TECHNICAL DATA

February, 2009

ASSA ABLOY, the global leader in door opening solutions

AVAILABLE WITH TYPE 1, 3, AND 9 WITH 3/8" POCKET ONLY

MUNTIN BAR PART NUMBER: CD002402

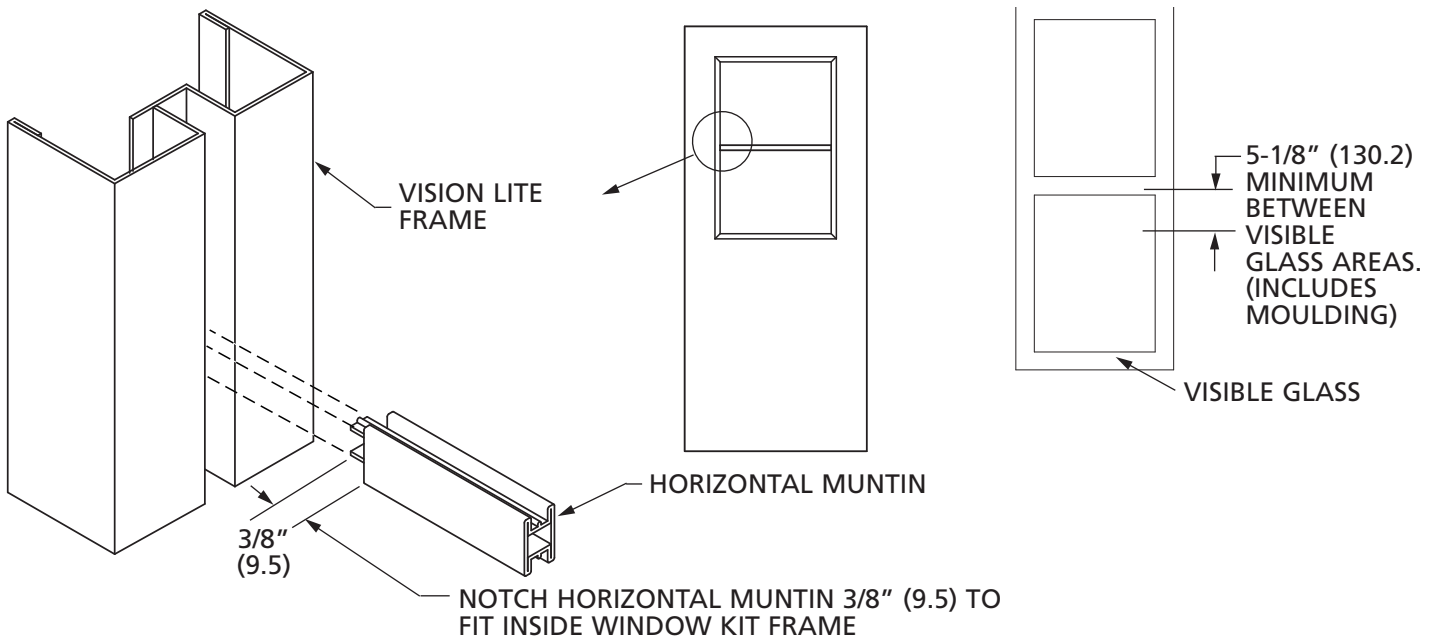
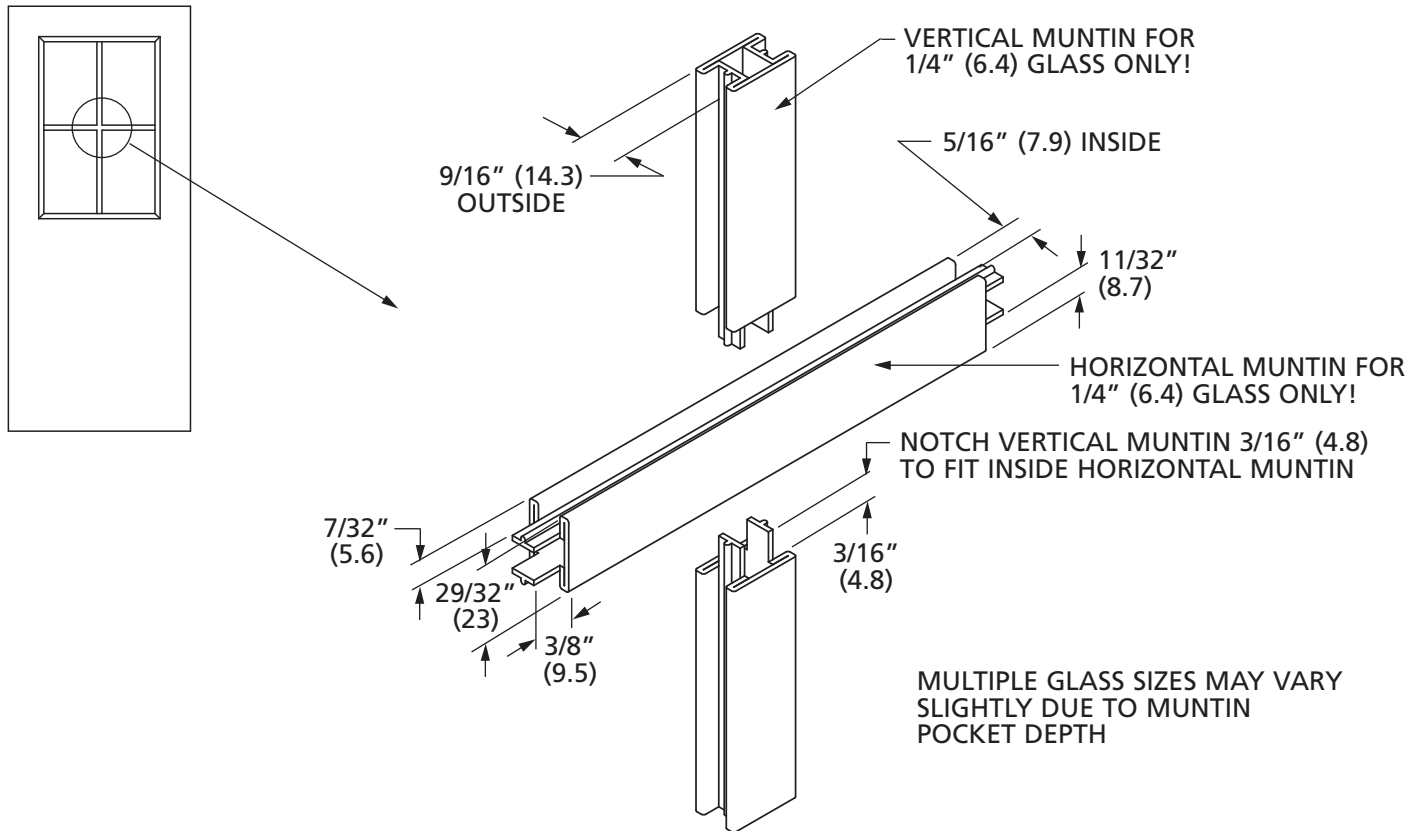

Type 9 Window Moulding



HINGE OR LOCK CHANNEL

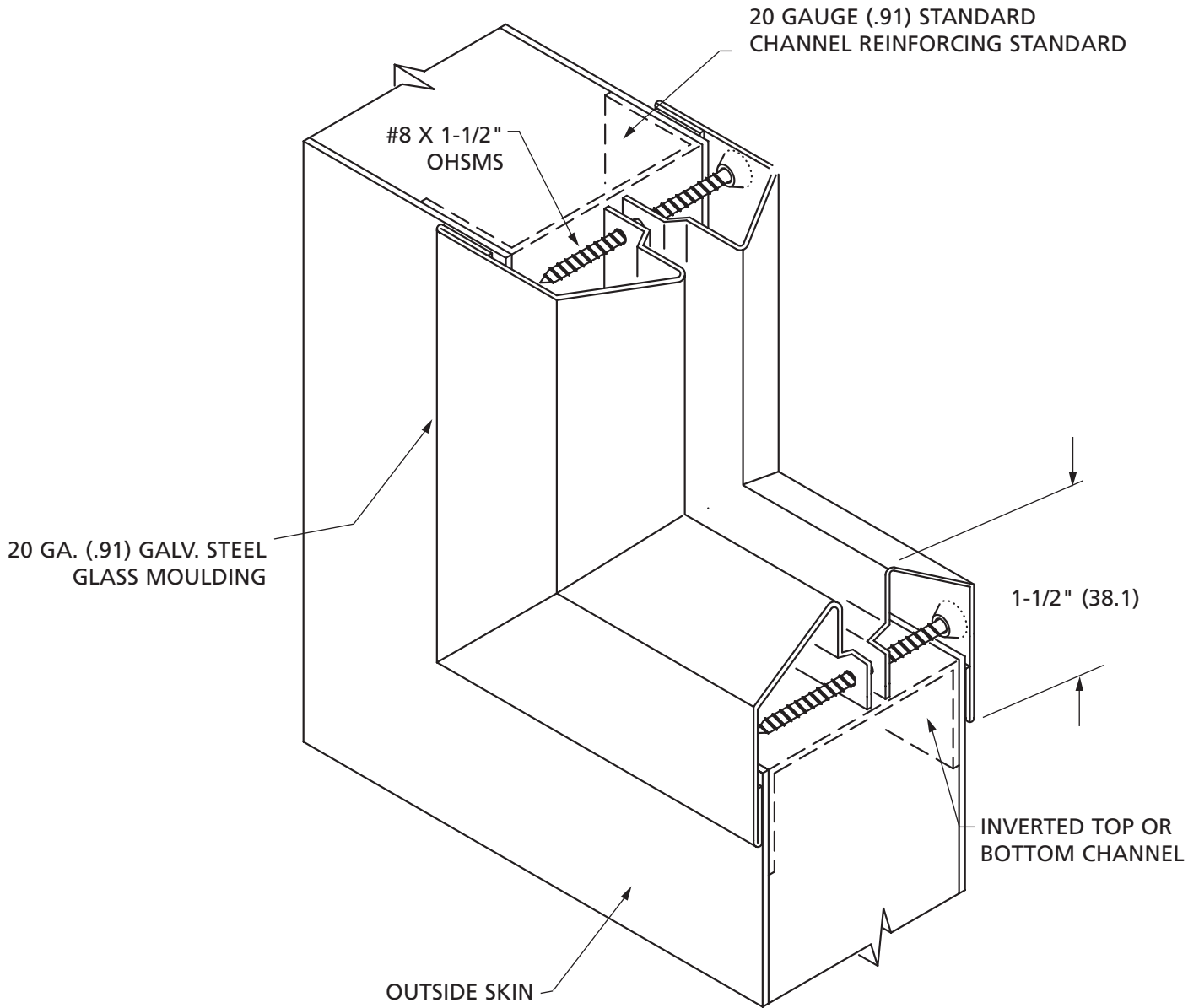

DOOR TECHNICAL DATA

February, 2009

ASSA ABLOY, the global leader
 in door opening solutions

Type 9 & 10 Window Moulding

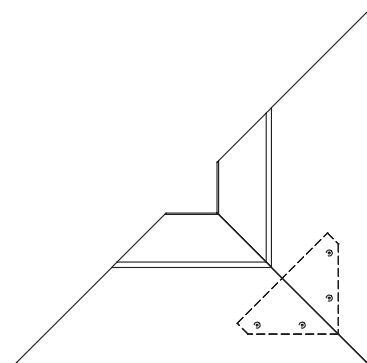
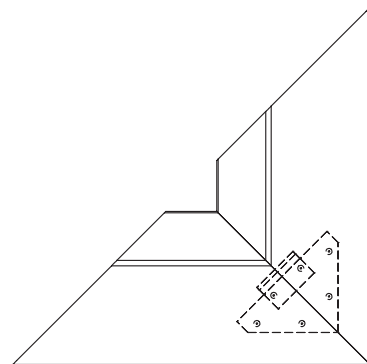
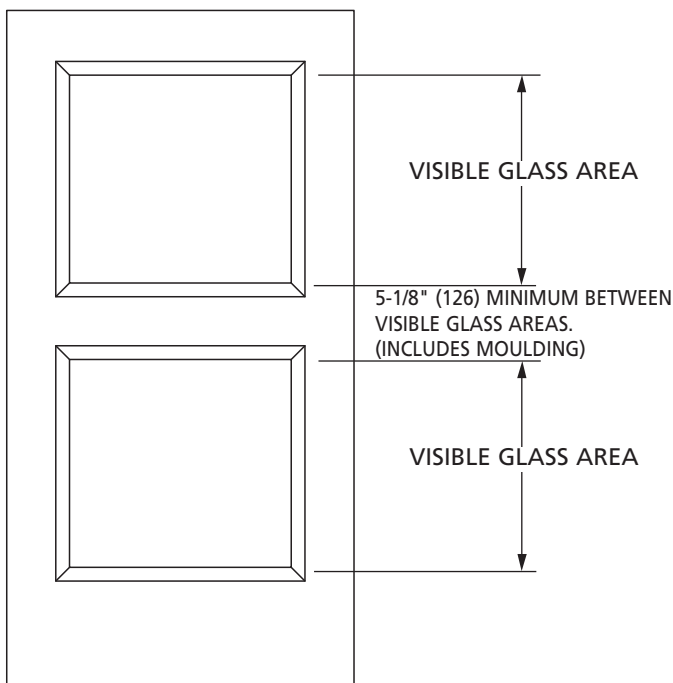
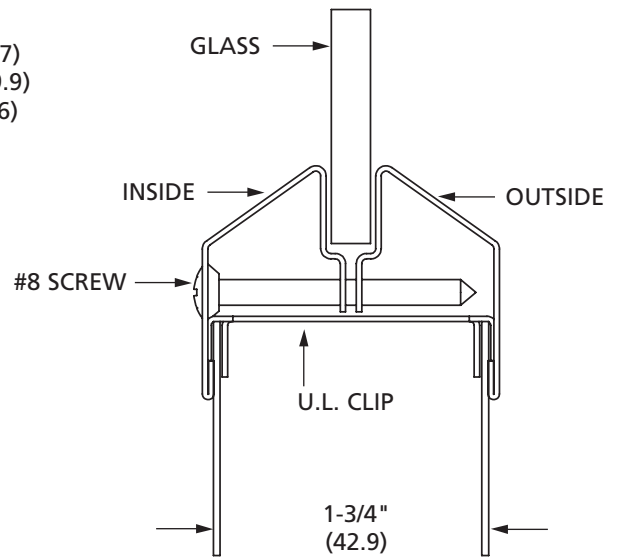
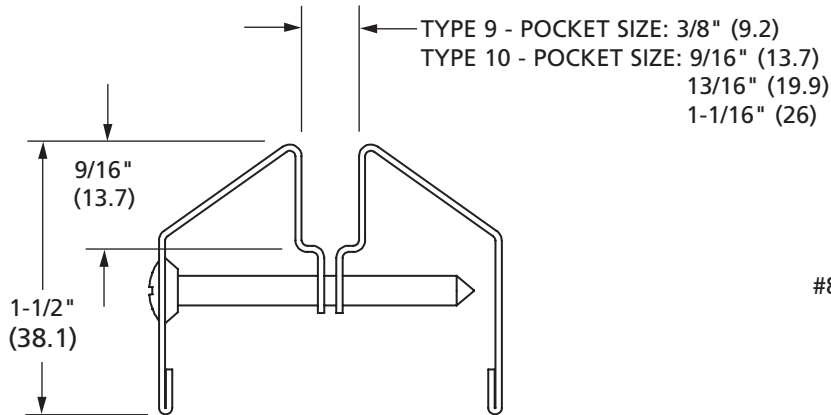

NOTE: ON FIRE LABEL DOORS USE A 6" (152.4) MINIMUM STILE BETWEEN VISIBLE GLASS AREAS AND BETWEEN VISIBLE GLASS AND EDGES OF DOOR.